

Instruction Manual



Battery tool
for Blind Rivets

POP® PB2500 Battery Powered Blind Rivet Tool

Battery Power Tool

Figure 1

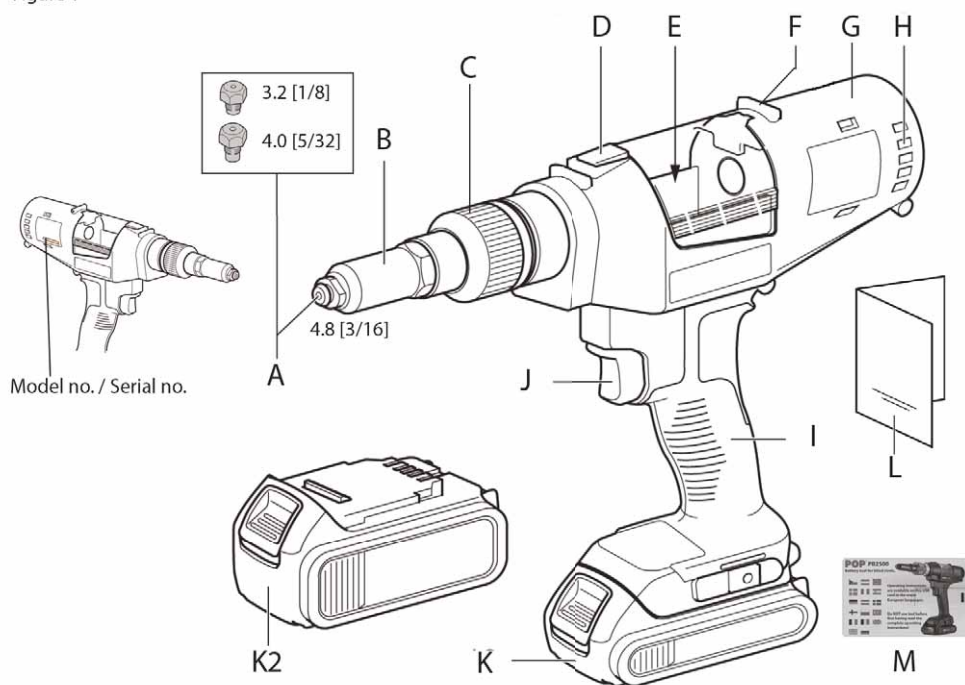

Figure 2

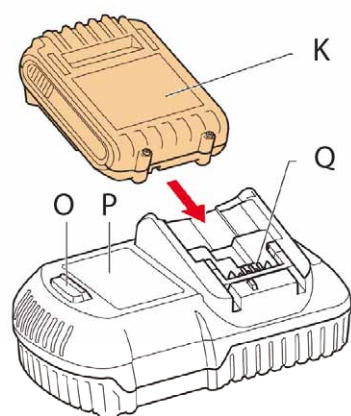

Figure 3

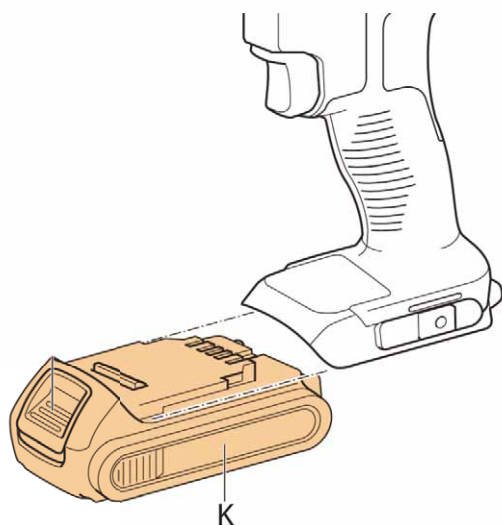

Figure 4

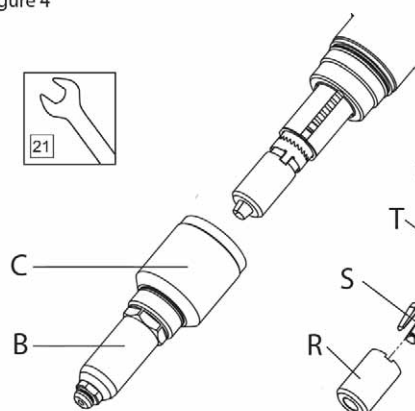

Figure 5

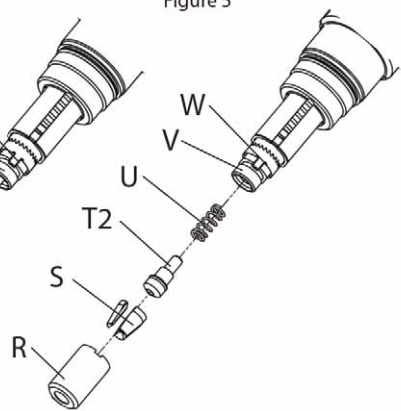

Figure 6

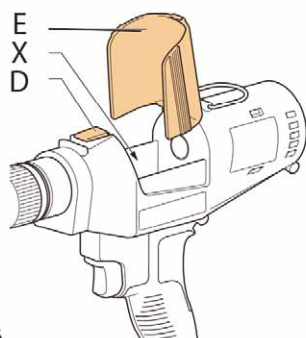

Figure 7

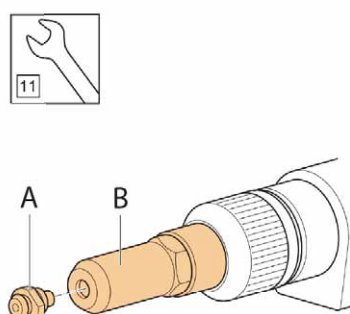

Figure 8

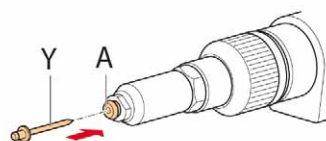

Figure 9

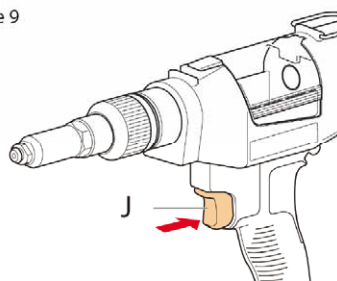
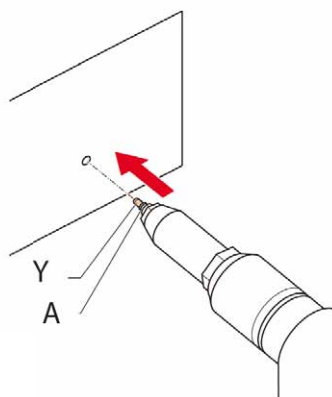

Figure 10



© 2015 Stanley Black & Decker Inc.

All rights reserved.

The information provided may not be reproduced and/or made public in any way and through any means (electronically or mechanically) without prior explicit and written permission from STANLEY Engineered Fastening. The information provided is based on the data known at the moment of the introduction of this product. STANLEY Engineered Fastening pursues a policy of continuous product improvement and therefore the products may be subject to change. The information provided is applicable to the product as delivered by STANLEY Engineered Fastening. Therefore, STANLEY Engineered Fastening cannot be held liable for any damage resulting from deviations from the original specifications of the product.

The information available has been composed with the utmost care. However, STANLEY Engineered Fastening will not accept any liability with respect to any faults in the information nor for the consequences thereof. STANLEY Engineered Fastening will not accept any liability for damage resulting from activities carried out by third parties. The working names, trade names, registered trademarks, etc. used by STANLEY Engineered Fastening should not be considered as being free, pursuant to the legislation with respect to the protection of trade marks.

Model		PB2500 EBC181/EBC183	PB2500 EBC180
Weight	kg [lbs]	1.7 [3.75]	2.0 [4.41]
Length	mm [in]	320 [12.6]	320 [12.6]
Height	mm [in]	240 [9.4]	260 [10.2]
Stroke	mm [in]	25 [0.984]	25 [0.984]
Pulling Force	N [lbf]	8,500 [1911]	8,500 [1911]
Rivet Range	nom. dia.	size 3 (ø 2.4 [3/32"]) thru size 6 (ø 4.8 [3/16"])	

Estimated Rivets per Charge*

Nom. Rivet Dia.	EBC181 battery (18 V, 1.5 Ah)	EBC183 battery (18 V, 2.0 Ah)	EBC180 battery (18 V, 3.0 Ah)
size 3 ø 2.4 [3/32]	1,300	1,700	2,600
size 4 ø 3.2 [1/8]	1,200	1,600	2,400
size 5 ø 4.0 [5/32]	1,100	1,400	2,200
size 6 ø 4.8 [3/16]	900	1,200	1,800
* The values are listed as a guide only and are estimates based on a fully charged battery. Results may vary depending on rivet material, tool/battery condition and work environment.			

Placing capacity for different type rivets

Rivet Type	PLACING CAPACITY								
	2.0 mm	2.4 mm [3/32"]	3.0 mm	3.2 mm [1/8"]	4.0 mm [5/32"]	4.8 mm [3/16"]	5.0 mm	6.0 mm	7.0 mm
OPEN END	●†	●**		●	●	●			
CLOSED END				●*	●*	●*			
AVEX®/STAVEX®			●	●	●	●			
AVINOX®/AVIBULB®				●	●	●*			
HR/HT				●	●	●*			
INTERLOCK®						●*			
KLAMP-TITE®						●			
BULBEX®/LS/TL				●	●	●			
MONOBOLT®						●†			
MULTI-GRIP				●	●	●			
PULL-THRU (PT)			●†	●†					
Q RIVET				●	●	●			
T LOK®						●			
T-RIVET						●†			
AVSEAL® II					●†		●†	●†	●†

* Non Standard Nose Piece required
** Non Standard Nose Piece and Jaws required
† Contact STANLEY Engineered Fastening, Applications Engineering for assistance

CONTENT

1.	EC-Declaration of Conformity.....	8
2.	Technical Data.....	9
3.	Definitions: Safety Guidelines.....	9
4.	General Power Tool Safety Warnings.....	9
5.	Additional Specific Safety Rules for Blind rivet tools.....	11
6.	Residual Risks.....	11
7.	Markings on Tool.....	11
8.	Important Safety Instructions for All Battery Chargers.....	11
9.	Chargers.....	12
10.	Chargers Procedures.....	12
11.	Charging Process.....	12
12.	Hot/Cold Pack Delay.....	12
13.	Important Safety Instructions for All Battery Packs.....	12
14.	Battery Packs.....	13
15.	Storage Recommendations.....	13
16.	Labels on Charger and Battery Pack.....	13
17.	Package contents.....	13
18.	Description.....	14
19.	Intended use.....	14
20.	Electrical Safety.....	14
21.	Using an Extension Cable.....	14
22.	Assembly & Adjustments.....	15
23.	Inserting and Removing the Battery Pack from the Tool.....	15
24.	Belt Hook and Bit Clip.....	15
25.	Operation.....	15
26.	Proper Hand Position.....	15
27.	Tool Setup & Mandrel Collection.....	15
28.	Use.....	16
29.	Cleaning and Maintenance.....	16
30.	Cleaning.....	16
31.	Optional Accessories.....	16
32.	Protecting the Environment.....	17
33.	Rechargeable Battery Pack.....	17
34.	Protect your Investment! Register Your Rivet Tool.....	17
35.	USB with manual in other European languages.....	18
36.	Parts List.....	18
37.	Exploded View Diagram.....	20
38.	Nose piece, Jaw and Jawpusher chart.....	21
39.	Trouble shooting guide.....	22



1. EC Declaration of Conformity

Company
Tucker GmbH
Max-Eyth-Straße 1
35394 Gießen
Germany

No. KFE-PB2500-01

Declare in their sole responsibility that the product:

POP[®] **Battery tool for blind rivets**
Type: PB2500

conforms to all the applicable regulations of the Machinery Directive
The above product follows the provision of the following EC Directives:

2006/42/EC Machinery Directive

2004/108/EC Electromagnetic compatibility

References of directives according to publication in Official Journal of the European Union.

The following harmonised European standards were applied:

• **EN 60745-1:2009**

Hand-held motor-operated electric tools
Safety - Part 1: General requirements.

• **EN 60745-2-2:2010**

Hand-held motor-operated electric tools
Safety - Part 2-2: Particular requirements.

Issued by: Manfred Müller, General Manager

Place, Date: Gießen, 23.01.2013

Legally binding signature:

This declaration certifies compliance with the named Directives.

The safety instructions on the supplied product information sheet are to be followed.

A StanleyBlack&Decker, Inc. Company

BATTERY TOOL FOR BLIND RIVETS

PB2500

Congratulations!

You have chosen a POP® tool. Years of experience, thorough product development and innovation make POP® one of the most reliable partners for professional blind rivet tool users.

2. Technical data

PB2500		
Voltage	V	18
Type		1/2
Battery Type		Li-Ion
Weight (without battery pack)	kg	1.35
L_{pa} (sound pressure)	dB(A)	74
K_{pa} (sound pressure uncertainty)	dB(A)	3
L_{pA} (sound power)	dB(A)	85
K_{pA} (sound power uncertainty)	dB(A)	3
Vibration total values (triax vector sum) determined according to EN 60745:		
Vibration emission value a_h		
$a_h =$	m/s^2	<2.5
Uncertainty $K =$	m/s^2	1.5

The vibration emission level given in this information sheet has been measured in accordance with a standardised test given in EN 60745 and may be used to compare one tool with another. It may be used for a preliminary assessment of exposure.



WARNING: The declared vibration emission level represents the main applications of the tool. However if the tool is used for different applications, with different accessories or poorly maintained, the vibration emission may differ. This may significantly increase the exposure level over the total working period.

An estimation of the level of exposure to vibration should also take into account the times when the tool is not used or when it is running but not actually setting a rivet. This may significantly reduce the exposure level over the total working period.

Identify additional safety measures to protect the operator from the effects of vibration such as: maintain the tool and the accessories, keep the hands warm, organisation of work patterns.

Battery pack	EBC181/EBC183/EBC180	
	all versions	
Battery type	Li-Ion	
Voltage	V_{dc}	18
Capacity	Ah	1.5/2.0/3.0
Weight	kg	0.35/0.37/0.64
Charging duration	min	30/40/60

Charger	EBC101		EBC105
	NA		QW/GB/XE
Battery Type	Li-Ion		Li-Ion
Battery type Mains voltage	V_{ac}	120	230
Input Frequency	Hz	60	50
Weight	kg	0.55	0.55

Fuses

Europe 230 V tools 10 Amperes, mains

3. Definitions: Safety Guidelines

The definitions below describe the level of severity for each signal word. Please read the manual and pay attention to these symbols.



DANGER: Indicates an imminently hazardous situation which, if not avoided, **will** result in **death or serious injury**.



CAUTION: Indicates a potentially hazardous situation which, if not avoided, **may** result in **minor or moderate injury**.



WARNING: Indicates a potentially hazardous situation which, if not avoided, **could** result in **death or serious injury**.

NOTICE: Indicates a practice **not related to personal injury** which, if not avoided, **may** result in **property damage**.



Denotes risk of electric shock



Denotes risk of fire

4. General Power Tool Safety Warnings



WARNING: To reduce the risk of injury, read the instruction manual.



WARNING! Read all safety warnings and all instructions. Failure to follow the warnings and instructions may result in electric shock, fire and/or serious injury.

SAVE ALL WARNINGS AND INSTRUCTIONS FOR FUTURE REFERENCE

The term “power tool” in the warnings refers to your mains-operated (corded) power tool or battery-operated (cordless) power tool.

4.1 WORK AREA SAFETY

- a) **Keep work area clean and well lit.** Cluttered or dark areas invite accidents.
- b) **Do not operate power tools in explosive atmospheres, such as in the presence of flammable liquids, gases or dust.** Power tools create sparks which may ignite the dust or fumes.
- c) **Keep children and bystanders away while operating a power tool.** Distractions can cause you to lose control.

4.2 ELECTRICAL SAFETY

- a) **Avoid body contact with earthed or grounded surfaces such as pipes, radiators, ranges and refrigerators.** There is an increased risk of electric shock if your body is earthed or grounded.
- b) **Do not expose power tools to rain or wet conditions.** Water entering a power tool will increase the risk of electric shock.

4.3 PERSONAL SAFETY

- a) **Stay alert, watch what you are doing and use common sense when operating a power tool. Do not use a power tool while you are tired or under the influence of drugs, alcohol or medication.** A moment of inattention while operating power tools may result in serious personal injury.
- b) **Use personal protective equipment. Always wear eye protection.** Protective equipment such as dust mask, non-skid safety shoes, hard hat, or hearing protection used for appropriate conditions will reduce personal injuries.
- c) **Prevent unintentional starting. Ensure the switch is in the off-position before connecting to the power source and/or battery pack, picking up or carrying the tool.** Carrying power tools with your finger on the switch or energising power tools that have the switch on invites accidents.
- d) **Remove any adjusting key or wrench before turning the power tool on.** A wrench or a key left attached to a rotating part of the power tool may result in personal injury.
- e) **Do not overreach. Keep proper footing and balance at all times.** This enables better control of the power tool in unexpected situations.
- f) **Dress properly. Do not wear loose clothing or jewellery. Keep your hair, clothing and gloves away from moving parts.** Loose clothes, jewellery or long hair can be caught in moving parts.

4.4 POWER TOOL USE AND CARE

- a) **Do not force the power tool. Use the correct power tool for your application.** The correct power tool will do the job better and safer at the rate for which it was designed.
- b) **Do not point the tool at anyone or look directly at the front of the tool while the battery is installed.** Debris can eject from the front of the tool when activated.
- c) **Do not use the power tool if the switch does not turn it on and off.** Any power tool that cannot be controlled with the switch is dangerous and must be repaired.
- d) **Disconnect the plug from the power source and/or the battery pack from the power tool before making any adjustments, changing accessories, or storing power tools.** Such preventive safety measures reduce the risk of starting the power tool accidentally.
- e) **Store idle power tools out of the reach of children and do not allow persons unfamiliar with the power tool or these instructions to operate the power tool.** Power tools are dangerous in the hands of untrained users.
- f) **Maintain power tools. Check for misalignment or binding of moving parts, breakage of parts and any other condition that may affect the power tool's operation. If damaged, have the power tool repaired before use.** Many accidents are caused by poorly maintained power tools.
- g) **Keep cutting tools sharp and clean.** Properly maintained cutting tools with sharp cutting edges are less likely to bind and are easier to control.
- h) **Use the power tool, accessories and tool bits etc., in accordance with these instructions taking into account the working conditions and the work to be performed.** Use of the power tool for operations different from those intended could result in a hazardous situation.

4.5 BATTERY TOOL USE AND CARE

- a) **Recharge only with the charger specified by the manufacturer.** A charger that is suitable for one type of battery pack may create a risk of fire when used with another battery pack.
- b) **Use power tools only with specifically designated battery packs.** Use of any other battery packs may create a risk of injury and fire.
- c) **When battery pack is not in use, keep it away from other metal objects like paper clips, coins, keys, nails, screws or other small metal objects that can make a connection from one terminal to another.** Shorting the battery terminals together may cause burns or a fire.
- d) **Under abusive conditions, liquid may be ejected from the battery, avoid contact. If**

contact accidentally occurs, flush with water. If liquid contacts eyes, additionally seek medical help. Liquid ejected from the battery may cause irritation or burns.

4.6 SERVICE

- a) **Have your power tool serviced by a qualified repair person using only identical replacement parts.** This will ensure that the safety of the power tool is maintained.

5. Additional Specific Safety Rules for Blind rivet tools

- **Hold power tool by insulated gripping surfaces when performing an operation where the fastener may contact hidden wiring.** Fasteners contacting a "live" wire may make exposed metal parts of the power tool "live" and could give the operator an electric shock.

6. Residual Risks

In spite of the application of the relevant safety regulations and the implementation of safety devices, certain residual risks cannot be avoided. These are:

- Impairment of hearing.
- Risk of personal injury due flying particles.
- Risk of burns due to accessories becoming hot during operation.
- Risk of personal injury due to prolonged use.

7. Markings on Tool

The following pictograms are shown on the tool:



Read instruction manual before use.



Discard the tools with due care for the environment.

DATE CODE POSITION

The Battery Date Code, which also includes the year of manufacture, is printed into the housing surface that forms the mounting joint between tool and battery.

8. Important Safety Instructions for All Battery Chargers

SAVE THESE INSTRUCTIONS: This manual contains important safety and operating instructions for the EBC105 battery charger.

- Before using the charger, read all instructions and cautionary markings on charger, battery pack and product using the battery pack.



WARNING: Shock hazard. Do not allow any liquid to get inside charger. Electric shock may result.



CAUTION: Burn hazard. To reduce the risk of injury, charge only POP® rechargeable battery packs. Other types of batteries may overheat and burst resulting in personal injury and property damage.



CAUTION: Children should be supervised to ensure that they do not play with the appliance.

NOTICE: Under certain conditions, with the charger plugged in to the power supply, the exposed charging contacts inside the charger can be shorted by foreign material. Foreign materials of a conductive nature such as, but not limited to, steel wool, aluminium foil or any build-up of metallic particles should be kept away from charger cavities. Always unplug the charger from the power supply when there is no battery pack in the cavity. Unplug charger before attempting to clean.

- **DO NOT attempt to charge the battery pack with any chargers other than the ones in this manual.** The charger and battery pack are specifically designed to work together.
- **These chargers are not intended for any uses other than charging POP® rechargeable batteries.** Any other uses may result in risk of fire, electric shock or electrocution.
- **Do not expose charger to rain or snow. Pull by plug rather than cord when disconnecting charger.** This will reduce risk of damage to electric plug and cord.
- **Make sure that cord is located so that it will not be stepped on, tripped over or otherwise subjected to damage or stress. Do not use an extension cord unless it is absolutely necessary.** Use of improper extension cord could result in risk of fire, electric shock or electrocution.
- **When operating a charger outdoors, always provide a dry location and use an extension cord suitable for outdoor use.** Use of a cord suitable for outdoor use reduces the risk of electric shock.
- **Do not block the ventilation slots on the charger.** The ventilation slots are located on the top and sides of the charger. Place the charger in a position away from any heat source.
- **Do not operate charger with damaged cord or plug — have them replaced immediately.**
- **Do not operate charger if it has received a sharp blow, been dropped or otherwise damaged in any way.** Take it to an authorised service centre.

- **Do not disassemble the charger; take it to an authorised service centre when service or repair is required.** Incorrect reassembly may result in a risk of electric shock, electrocution or fire.
- In case of damaged power supply cord the supply cord must be replaced immediately by the manufacturer, its service agent or similar qualified person to prevent any hazard.
- **Disconnect the charger from the outlet before attempting any cleaning. This will reduce the risk of electric shock.** Removing the battery pack will not reduce this risk.
- **NEVER** attempt to connect 2 chargers together.
- **The charger is designed to operate on the voltage specified in the Charger Specifications chart. Do not attempt to use it on any other voltage.** Refer to your Charger Model No. for the correct specification.

SAVE THESE INSTRUCTIONS

9. Chargers

The EBCB105 charger accepts EBC180, EBC181 & EBC183, 18 V Li-Ion battery packs.

This charger requires no adjustment and is designed to be as easy as possible to operate.



10. Charging Procedures (fig. 2)



1. Plug the charger into an appropriate outlet before inserting the battery pack. (Refer to the Charger Specifications)
2. Insert the battery pack (K) into the charger, making sure the pack is fully seated in the charger. The red (charging) light will blink continuously indicating that the charging-process has started.
3. The completion of charge will be indicated by the red light remaining ON continuously. The pack is fully charged and may be used at this time or left in the charger.

NOTE: To ensure maximum performance and life of Li-Ion battery packs, charge the battery for a minimum of 10 hours before first use.

11. Charging Process

Refer to the table below for the state of charge of the battery pack.

State of charge		
	charging	-----
	fully charged	-----
	hot/cold pack delay	---.---.---

State of charge		
	problem pack or charger
	problem power line

This charger will not charge a faulty battery pack. The charger will indicate faulty battery by refusing to light or by displaying problem pack or charger blink pattern.

NOTE: This could also mean a problem with a charger. If the charger indicates a problem, take the charger and battery pack to be tested at an authorised service centre.

12. Hot/Cold Pack Delay

When the charger detects a battery that is too hot or too cold, it automatically starts a hot/cold pack delay, suspending charging until the battery has reached an appropriate temperature. The charger then automatically switches to the pack charging mode. This feature ensures maximum battery life. STANLEY Engineered Fastening Li-Ion tools are designed with an Electronic Protection System that will protect the battery against overloading, overheating or deep discharge. The tool will automatically turn off if the Electronic Protection System engages. If this occurs, place the Li-Ion battery on the charger until it is fully charged. A cold battery pack will charge at about half the rate of a warm battery pack. The battery pack will charge at that slower rate throughout the entire charging cycle and will not return to maximum charge rate even if the battery warms.

13. Important Safety Instructions for All Battery Packs

When ordering replacement battery packs, be sure to include the catalogue number and voltage. The battery pack is not fully charged out of the carton. Before using the battery pack and charger, read the safety instructions below and then follow the charging procedures outlined.

READ ALL INSTRUCTIONS

- **Do not charge or use the battery pack in explosive atmospheres, such as in the presence of flammable liquids, gases or dust.** Inserting or removing the battery pack from the charger may ignite the dust or fumes.
- **Never force the battery pack into charger. Do not modify the battery pack in any way to fit into a non-compatible charger as battery pack may rupture causing serious personal injury.**
- Charge the battery packs only in designated POP® chargers.

- **DO NOT** splash or immerse in water or other liquids.
- **Do not store or use the tool and battery pack in locations where the temperature may reach or exceed 40 °C (105 °F) (such as outside sheds or metal buildings in summer).**
- For best results, make sure the battery pack is fully charged before use.



WARNING: Never attempt to open the battery pack for any reason. If the battery pack case is cracked or damaged, do not insert it into the charger. Do not crush, drop or damage battery pack. Do not use a battery pack or charger that has received a sharp blow, been dropped, run over or damaged in any way (e.g., pierced with a nail, hit with a hammer, stepped on). Electric shock or electrocution may result. Damaged battery packs should be returned to the service centre for recycling.



CAUTION: When not in use, place tool on its side on a stable surface where it will not cause a tripping or falling hazard. Some tools with large battery packs will stand upright on the battery pack but may be easily knocked over.

SPECIFIC SAFETY INSTRUCTIONS FOR LITHIUM ION (LI-ION)

- **Do not incinerate the battery pack even if it is severely damaged or is completely worn out.** The battery pack can explode in a fire. Toxic fumes and materials are created when lithium ion battery packs are burned.
- **If battery contents come into contact with the skin, immediately wash the area with mild soap and water.** If the battery liquid gets into the eye, rinse water over the open eye for 15 minutes or until irritation ceases. If medical attention is needed, the battery electrolyte is composed of a mixture of liquid organic carbonates and lithium salts.
- **Contents of opened battery cells may cause respiratory irritation.** Provide fresh air. If symptoms persist, seek medical attention.



WARNING: Burn hazard. Battery liquid may be flammable if exposed to spark or flame.

14. Battery Packs

BATTERY TYPE

The PB2500 operates on 18 volt battery pack. EBC180, EBC181 & EBC183 battery packs may be used. Refer to Technical Data for more information.

15. Storage Recommendations

1. The best storage place is one that is cool and dry away from direct sunlight and excess heat or cold. For optimum battery performance and life, store battery packs at room temperature when not in use.
2. For long storage, it is recommended to store a fully charged battery pack in a cool, dry place out of the charger for optimal results.

NOTE: Battery packs should not be stored completely depleted of charge. The battery pack will need to be recharged before use.

16. Labels on Charger and Battery Pack

In addition to the pictographs used in this manual, the labels on the charger and the battery pack show the following pictographs.



Read instruction manual before use.



Battery charging.



Battery charged.



Hot/cold pack delay.



Problem pack or charger.



Problem power line.



Do not probe with conductive objects.



Do not charge damaged battery packs.



Use only with POP® battery packs. Others may burst causing personal injury and damage.



Do not expose to water.



Have defective cords replaced immediately.



Charge only between 4 °C and 40 °C.



Discard the battery pack with due care for the environment.



LI-ION



Do not incinerate the battery pack.



Charges Li-Ion battery packs.



See Technical Data for charging time.



Only for indoor use.

17. Package contents

The package contains:

- 1 PB2500 tool with nose piece size \varnothing 4.8 [3/16]
- 1 Charger 20 V max.
- 1 Battery 18 V Lithium Ion
- 1 Converter Plug for the UK (European tools only)
- 1 Bag with nose piece and matching jaw pusher assembly extended tube size 4 (\varnothing 3.2 [1/8])
- 1 Bag with nose piece and matching jaw pusher assembly extended tube size 5 (\varnothing 4.0 [5/32])
- 1 Instruction Manual

NOTE:

- Check for damage to the tool, parts or accessories which may have occurred during transport.
- Take the time to thoroughly read and understand this manual prior to operation.

18. Description (fig. 1)

Components Fig. 1, 2 & 3

- A. Nose Pieces
- B. Nose housing
- C. Nose housing nut
- D. Collector lock
- E. Collector shutter
- F. Shutter guide sleeve
- G. Motor housing
- H. Exhaust vent
- I. Handle
- J. Switch
- K. Battery Pack 1.5/2.0 Ah
- K2. Battery Pack 3.0 Ah
- L. Manual
- M. USB Card with Manuals in EU languages
- N. Charger lamp
- O. Charger

Q. Battery charger connection

Components Fig. 4&5

- R. Jaw guide
- S. Jaws
- T. Jaw pusher with extended tube size 4 (\varnothing 3.2 [1/8]) or size 5 (\varnothing 4.0 [5/32])
- T2. Jaw pusher size 6 (\varnothing 4.8 [3/16])
- U. Spring
- V. Pulling Head
- W. Font Clutch (Jaw case lock)
- X. Mandrel collector
- Y. Blind rivet

19. INTENDED USE

This blind riveting power tool is designed for professional blind rivet setting applications.



WARNING: Never modify the power tool or any part of it. Damage or personal injury could result.

DO NOT use under wet conditions or in presence of flammable liquids or gases.

This blind riveter is a professional power tool.

DO NOT let children come into contact with the tool. Supervision is required when inexperienced operators use this tool.

- This product is not intended for use by persons (including children) suffering from diminished physical, sensory or mental abilities, or for lack of experience and/or for want of knowledge or skills unless they are supervised by a person responsible for their safety. Children should never be left alone to play with this product.

20. Electrical Safety

The electric motor has been designed for one voltage only. Always check that the battery pack voltage corresponds to the voltage on the rating plate. Also make sure that the voltage of your charger corresponds to that of your mains.



Your POP® charger is double insulated in accordance with EN 60335; therefore no earth wire is required.

If the supply cord is damaged, it must be replaced by a specially prepared cord available through the POP® service organisation.

21. Using an Extension Cable

An extension cord should not be used unless absolutely necessary. Use an approved extension cable suitable for the power input of your charger

(see **technical data**). The minimum conductor size is 1.5 mm²; the maximum length is 30 m. When using a cable reel, always unwind the cable completely.

22. ASSEMBLY & ADJUSTMENTS



WARNING: Prior to assembly and adjustment, always remove the battery pack. Always switch off the tool before inserting or removing the battery pack.



WARNING: Use only POP® battery packs and chargers.

23. Inserting and Removing the Battery Pack from the Tool (fig. 3)

NOTE: For best results, make sure your battery pack is fully charged. The light will shut off without warning when the battery is fully discharged.

TO INSTALL THE BATTERY PACK INTO THE HANDLE

1. Align the battery pack (K) with the rails inside the tool's handle (fig. 3).
2. Slide it into the handle until the battery pack is firmly seated in the tool and ensure that it does not disengage.

TO REMOVE THE BATTERY PACK FROM TO THE HANDLE

1. Press battery release button and firmly pull the battery pack out of the tool handle.
2. Insert battery pack into the charger as described in the charger section for this manual.

24. Belt Hook and Bit Clip



WARNING: To reduce the risk of serious personal injury, **DO NOT** suspend tool overhead or suspend objects from the belt hook. **ONLY** hang tool's belt hook from a work belt.



WARNING: To reduce the risk of serious personal injury, ensure the screw holding the belt hook is secure.

IMPORTANT: When attaching or replacing the belt hook or bit clip, use only the screw that is provided. Be sure to securely tighten the screw. The belt hook and bit clip can be attached to either side of the tool using only the screw provided, to accommodate left- or right-handed users. If the hook or bit clip is not desired at all, it can be removed from the tool. To move belt hook or bit clip, remove the screw that holds it in place then reassemble on the opposite side. Be sure to securely tighten the screw.

25. OPERATION

Instructions for Use



WARNING: Always observe the safety instructions and applicable regulations.



WARNING: To reduce the risk of serious personal injury, disconnect battery pack before making any adjustments or removing/installing attachments or accessories.

26. Proper Hand Position



WARNING: To reduce the risk of serious personal injury, **ALWAYS** use proper hand position.



WARNING: To reduce the risk of serious personal injury, **ALWAYS** hold securely in anticipation of a sudden reaction.

Proper hand position requires one hand on the main handle fig. 1- (I).

27. Tool Setup & Mandrel Collection



WARNING: Before adjusting tool, always remove the battery pack.

Opening and closing the mandrel collector (fig. 6)

- The mandrel collector is used to collect the rest mandrel. To open the the mandrel collector (X), slide the release button (D) towards the nose housing nut (C) and raise the cover (E).
- To close the the mandrel collector (X), lower the cover (E) until the release button (D) clicks into place.

Mounting the nosepiece (fig. 7)

- Select the correct nosepiece for the rivet to be installed Ref. Nose Piece chart.
- Tighten the nosepiece into the front sleeve. (B) by turning it clockwise using 11 mm spanner.

Mounting the jaw pusher (fig. 5)

- Select the correct jaw pusher or jaw pusher assembly (T, T2) that matches the Nose Piece selected. Ref. Nose Piece chart.
- Insert small tube diameter into jaw pusher spring.
- Reassemble jaw set (S) and jaw case (R) onto jaw case lock (W).
- Note: Avoid spanners to mount jaw case (R) onto jaw case lock (W). Jaw case (R) manual tightening is enough to lock jaw case (R) onto front clutch (W).

28. Use

Place the rivet (fig. 8)

Place the blind rivet (Y) in the nose piece (A)

Position the tool (fig.10)

Switch operation (fig. 9)

- Pull and hold the switch (J) until the rivet is fully set in the application.
- If you release the switch (J) before the end of the setting stroke, the tool will immediately return to its initial position. If the blind rivet (Y) has not been set completely, repeat the previous steps.
- If the blind rivet (Y) has been set completely, release the switch (J). The tool will return to its initial position automatically. The mandrel is automatically dropped into the mandrel collector (X).

Reset function (fig. 9)

If the tool does not move to its initial position after releasing the switch or stops during the setting stroke, reset the tool to home by quickly pulling and releasing the switch (J). If this does not work review the Troubleshooting Guide.

29. Cleaning and Maintenance



WARNING: Before cleaning and maintenance, always remove the battery pack.

- Keep the ventilation openings free from dust and dirt. If necessary, use a soft, moist cloth to remove dust and dirt from the ventilation openings.

Emptying the mandrel collector

The mandrel collector must be emptied depending on the size of the blind rivets used.

Nom. Rivet Dia.	Approx. Capacity
2.4 mm [3/32"]	600
3.2 mm [1/8"]	360
4.0 mm [5/32"]	200
4.8 mm [3/16"]	150

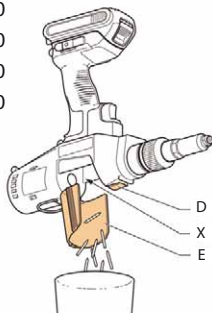

- Open the mandrel collector (X).
- Hold the tool upside down above a dustbin to empty the mandrel collector (X).
- Close the mandrel collector (X).

30. Cleaning



WARNING: Blow dirt and dust out of the main housing with dry air as often as dirt is seen collecting in and around the air vents. Wear approved eye protection and approved dust mask when performing this procedure.



WARNING: Never use solvents or other harsh chemicals for cleaning the non-metallic parts of the tool. These chemicals may weaken the materials used in these parts. Use a cloth dampened only with water and mild soap. Never let any liquid get inside the tool; never immerse any part of the tool into a liquid.

CHARGER CLEANING INSTRUCTIONS



WARNING: Shock hazard. Disconnect the charger from the AC outlet before cleaning. Dirt and grease may be removed from the exterior of the charger using a cloth or soft non-metallic brush. Do not use water or any cleaning solutions.

Cleaning the Nose Housing & Jaw Case (fig. 4 & 5)

- Loosen the nose housing nut (C). Remove the nose housing (B).
- Press the jaw case lock (W) and loosen the jaw guide (R). Release the jaw case lock (W).
- Remove the jaws (S) and the jaw pusher (T).
- Remove the spring (U).
- Clean the inside of the nose housing (B) using a dry cloth.
- Clean the clamping jaws (S) and the jaw pusher (T) using a dry cloth. If necessary, replace the jaws (S) and the jaw pusher (T).
- Clean the pulling head (V) using a dry cloth.
- Apply grease to the inside of the jaw guide (R) where the jaws (S) make contact. A Molybdenum Disulfide based grease is recommended.
- Mount the spring (U).
- Mount the jaw pusher (T) and the jaws (S).
- Press the jaw case lock (W) and tighten the jaw guide (R). Release the jaw case lock (W).
- Mount the nose housing (B). Tighten the nose housing nut (C).

31. Optional Accessories



WARNING: Since accessories, other than those offered by POP® have not been tested with this product, use of such accessories with this tool could be hazardous. To reduce the risk of injury, only POP® recommended

accessories should be used with this product.

Consult your dealer for further information on the appropriate accessories.



WARNING: To reduce the risk of serious personal injury, disconnect battery pack before making any adjustments or removing/installing attachments or accessories.

Maintenance Frequency

Item	Frequency
Clean & lubricate Nose Housing & Jaw Case	5,000 rivets
Clean & grease Ball Screw and Thrust Bearing	50,000 rivets*
*Recommend contacting authorized service centre	

32. Protecting the Environment



Separate collection. This product must not be disposed of with normal household waste.

Should you find one day that your POP® product needs replacement, or if it is of no further use to you, do not dispose of it with household waste. Make this product available for separate collection.



Separate collection of used products and packaging allows materials to be recycled and used again. Re-use of recycled materials helps prevent environmental pollution and reduces the demand for raw materials.

Local regulations may provide for separate collection of electrical products from the household, at municipal waste sites or by the retailer when you purchase a new product.

You can check the location of your nearest authorised repair agent by contacting your local POP® office at the address indicated in this manual. Alternatively, a list of authorised POP® repair agents and full details of our after-sales service and contacts are available on the Internet at:

www.StanleyEngineeredFastening.com.

33. Rechargeable Battery Pack

This long life battery pack must be recharged when it fails to produce sufficient power on jobs which were easily done before. At the end of its technical life, discard it with due care for our environment:

- Run the battery pack down completely, then remove it from the tool.

- Li-Ion cells are recyclable. Take them to your dealer or a local recycling station. The collected battery packs will be recycled or disposed of properly.

34. Protect your Investment! Register Your Rivet Tool.

POP® RIVET TOOL WARRANTY

STANLEY Engineered Fastening warrants that all power tools have been carefully manufactured and that they will be free from defect in material and workmanship under normal use and service for a period of one (1) year. This warranty applies to the first time purchaser of the tool for original use only.

Exclusions:

Normal wear and tear. Periodic maintenance, repair and replacement parts due to normal wear and tear are excluded from coverage.

Abuse & Misuse. Defect or damage that results from improper operation, storage, misuse or abuse, accident or neglect, such as physical damage are excluded from coverage.

Unauthorized Service or Modification. Defects or damages resulting from service, testing adjustment, installation, maintenance, alteration or modification in any way by anyone other than STANLEY Engineered Fastening, or its authorized service centres, are excluded from coverage.

All other warranties, whether expressed or implied, including any warranties of merchantability or fitness for purpose are hereby excluded.

Should this tool fail to meet the warranty, promptly return the tool to our factory authorized service centre location nearest you. For a list of POP Authorized Service Centres in the US or Canada, contact us at our toll free number (877)364 2781.

Outside the US and Canada, visit our website **www.StanleyEngineeredFastening.com** to find your nearest STANLEY Engineered Fastening location.

STANLEY Engineered Fastening will then replace, free of charge, any part or parts found by us to be defective due to faulty material or workmanship, and return the tool prepaid. This represents our sole obligation under this warranty. In no event shall STANLEY Engineered Fastening be liable for any consequential or special damages arising out of the purchase or use of this tool.

To register your warranty online, visit us <http://www.stanleyengineeredfastening.com/poppowertools/warranty-card>. Thank you for choosing an STANLEY Engineered Fastening's POP® Brand tool.

35. USB with manual in other European languages.

Operating instructions are available on this USB in other European languages. If for whatever reason you cannot read the USB or do not have the means to open the USB, please contact and we will send you a paper copy in the language requested.

Do not use tool before first having read the complete operating instructions!



36. Parts List

NO		Part Number	Description
C	1	TP124-542	Nosepiece Assembly, 4.8 mm [3/16"] size
C	2	TP124-503	O-Ring
	3	(See item 1)	Nosepiece
C	4	TP094-552	Steel Ball
C	9	PRS2500-01	Jaw Guide
C	10	71210-15001	Jaws - One Set (3)
C	11	TP154-500	Jaw Pusher Assembly, 4.8 mm [3/16"] size
	12	(See item 11)	Jaw Pusher
	13	TP124-501	O Ring
C	14	TP114-652	Jaw Pusher Spring
C	15	TP124-505	O Ring
	16	TP113-610	Mast Housing
	17	TP123-555	Pulling Head Assembly
	18	TP113-606	Spindle Clutch
	19	TP114-666	Spindle Clutch Spring
	20	TP114-637	Tail Guide
	21	TP123-553	Gear Housing Assembly
	29	TP123-551	SA Second Shaft
	30	TP123-550	SA Planetary Shaft
	31	N112877	Gear, Ring
	32	TP124-511	O Ring
	33	TP122-535	SA Motor and Module, PB2500
	34	TP114-628	Pipe Bridge
	35	TP114-665	Mandrel Plate
	36	TP114-676	Shutter Guide Sleeve

NO	Part Number	Description	
	37	TP124-677	Collector Shutter Lock Spring
	38	TP124-532	Collector Lock
	39	TP123-531	Collector Shutter
	†40	TP130-606	Housing Assembly PB2500 NA
		TP122-631	Housing Assembly PB2500 QW, GW
		TP122-662	Housing Assembly PB2500 XE
	41	TP124-513	Cross Recessed Pan Head Tapping Screw
	42	TP124-514	Cross Recessed Pan Head Tapping Screw
C	50	TP124-540	Nosepiece Assembly, 3.2 mm [1/8"] size
C	51	TP124-524	O Ring
	52	(See item 50)	Nosepiece
C	53	TP124-541	Nosepiece Assembly, 4.0 mm [5/32"] size
	54	(see item 53)	Nosepiece
C	55	TP154-502	Jaw Pusher Assembly, 3.2 mm [1/8"] size
	56	(see item 55)	Jaw Pusher
C	57	TP154-505	Jaw Pusher Assembly, 4.0 mm [5/32"] size
	58	(see item 57)	Jaw Pusher
C	†59	EBC183-()	2.0 Ah Battery, NA, QW, XE (Use QW with model no. PB2500-GB)
	†60	EBC-101NA	Battery Charger, PB2500 NA
		EBC105-()	Battery Charger, GB,QW,XE (Ref. PB2500-() model no.)
	61		SA Kit Box
	62	TP133-570	SA Nose Housing Assembly
C	*†	EBC-181()	1.5 Ah Battery, NA, QW, XE (use QW with model no. PG2500 GB)
C	*†	EBC-180()	3.0 Ah Battery, NA, QW, XE (use QW with model no. PG2500 GB)
	*†	PNT132-600	Hook, PB2500
"C"	Marked Parts are Consumable Not Warranted		
*	Marked Parts are Optional, Not offered as Standard Equipment		
	Shaded Parts are Recommended for Stainless Steel Rivets		
†	Select Part Number based on Tool Model Number: PB2500-NA, QW, GB, XE		

37. Exploded View Diagram

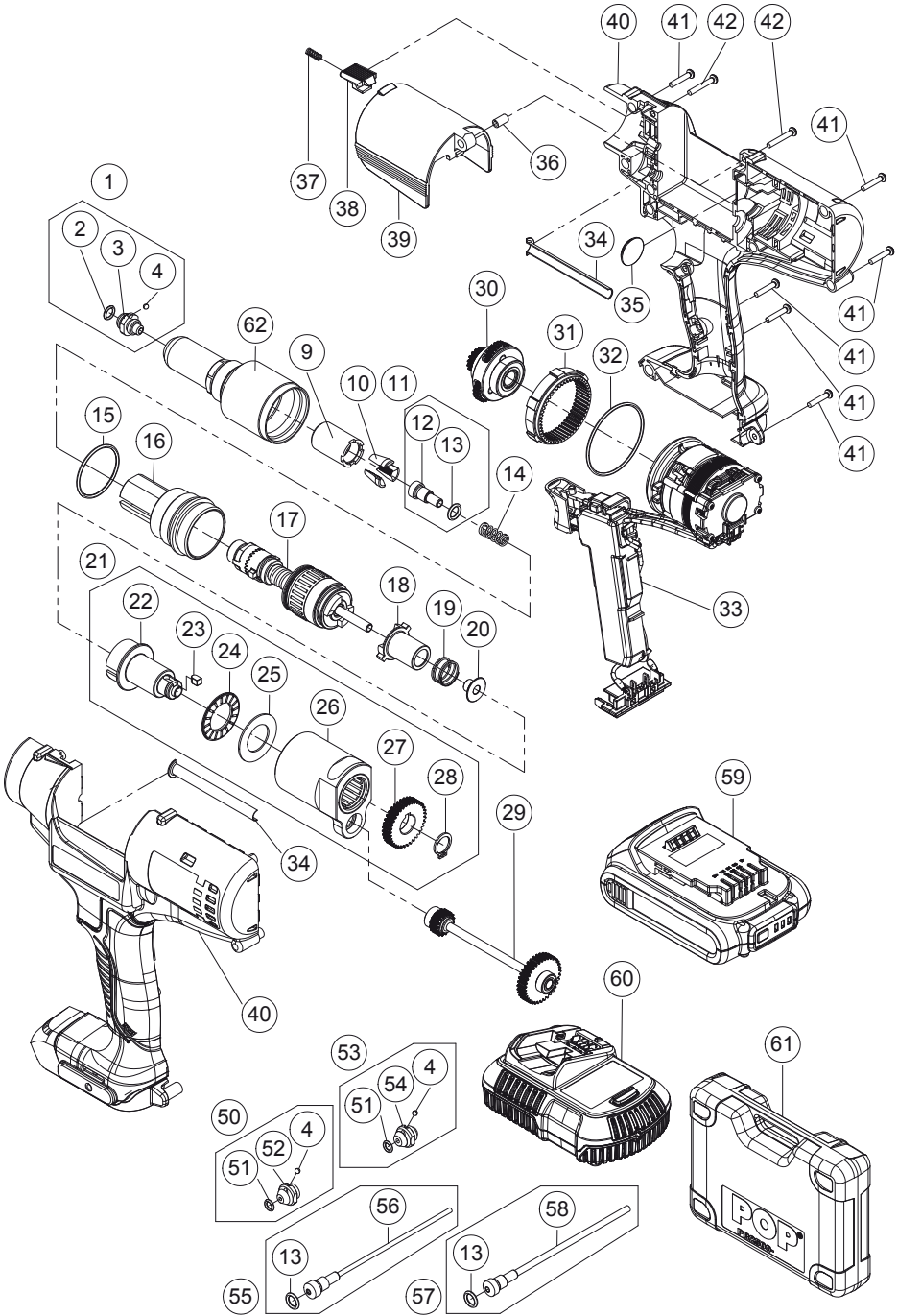

38. Nosepiece, Jaw and Jawpusher chart

NOSEPIECE SELECTION CHART

Size	Rivet Type	Material (Body/Mandrel)				
		All Mat'ls	Al/Al	Al/St, Al/SS	NiCu/St, NiCu/SS	St/St, SS/St, SS/SS
2.4 mm [3/32"]	Open End	TP124-539	-	-	-	-
3.0 mm	PT Rivet	TP124-540*	-	-	-	-
3.2 mm [1/8"]	Avex®/Avibulb®	TP124-540*	-	-	-	-
	Closed End	-	TP124-615	TP124-544	TP124-540*	TP124-540*
	HR/HT Rivet	-	TP124-541*	TP124-540*	-	TP124-541*
	Open End/LS Rivet	TP124-540*	-	-	-	-
	Stavex®/Avinox®	TP124-541*	-	-	-	-
4.0 mm [5/32"]	Avex®	TP124-541*	-	-	-	-
	Avinox®/Avibulb®	TP124-542*	-	-	-	-
	Closed End	TP124-545	-	-	-	-
	HR/HT Rivet	-	TP124-542*	TP124-541*	-	TP124-542*
	Open End/Bulbex®/TL	TP124-541*	-	-	-	-
4.8 mm [3/16"]	Stavex®	TP124-542*	-	-	-	-
	Avex®	TP124-542*	-	-	-	-
	Avinox®/Avibulb®	TP124-543	-	-	-	-
	Bulbex®/TL/Klamp-Tite***	TP124-542*	-	-	-	-
	Closed End	-	TP124-546	TP124-546	TP124-542*	TP124-542*
	HR/HT Rivet	-	TP124-543	TP124-542*	-	TP124-543
	Interlock®	TP124-542*	-	-	-	-
	Open End	TP124-542*	-	-	-	-
	Stavex®	TP124-542*	-	-	-	-

* Included with the standard tool kit

** Klamp-Tite® KTR series requires a Special Nosepiece, contact Applications Engineering

JAW & JAW PUSHER SELECTION CHART

Size	Rivet Type	Jaw		Jaw Pusher	
			Stainless Mandrel		Stainless Mandrel
2.4 mm [3/32"]	Open End	PRG540-46B	-	TP124-547	-
3.0 mm	PT Rivet	71210-15001	-	TP154-502	-
3.2 mm [1/8"]	Avex®	71210-15001 ¹⁾	PRG540-46B	TP154-502	TP124-638
	Avinox®/Avibulb®			TP154-502	
	Closed End			TP154-502	
	HR/HT Rivet			TP154-505 ²⁾	
	Open End/LS Rivet			TP154-502	
	Stavex®			TP154-505	
4.0 mm [5/32"]	Avex®	71210-15001	PRG540-46B	TP154-505	TP124-618
	Avinox®/Avibulb®			TP154-500	
	Closed End			TP154-505	
	HR/HT Rivet			TP154-500 ³⁾	
	Open End/Bulbex®/TL			TP154-505	
	Stavex®			TP154-500	
4.8 mm [3/16"]	Avex®/Stavex®	71210-15001	PRL650-01	TP154-500	TP124-620
	Avibulb®/Avinox®				
	Bulbex®/Klamp-Tite®				
	LS Rivet/TL Rivet				
	Open End/Closed End				
	HR/HT/Interlock®				

1) Recommend 71200-15001 Jaws for 3.2 mm [1/8"] Closed End with Steel Mandrel

2) Use TP154-502 Jaw Pusher with 3.2 mm [1/8"] Al/St HR Rivet

3) Use TP154-505 Jaw Pusher with 4.0 mm [5/32"] Al/St HR Rivet

39. Troubleshooting guide

Symptom	Cause	Remedy
Tool stops before rivet is fully set	Setting load of rivet is beyond tool capacity.	Reset tool to home, remove rivet & use appropriate tool to set rivet.
	Improper nosepiece selection.	Reset tool to home, remove rivet & fit proper nose piece.
	Battery pack has reached operating temperature limit through continuous use or defect.	Remove battery & allow to cool. Mount battery and reset tool to home.
Tool does not return to initial position when switch is released.	Electrical malfunction.	Remove battery, wait 5 seconds and reinsert. Reset tool to home.
Tool does not operate when switch is pressed.	Battery is not fully seated	Remove battery and re-insert. Reset tool to home.
	Battery is not fully charged	Charge battery
	Battery pack has reached operating temperature limit through continuous use or defect.	Remove battery & allow to cool. Mount battery and reset tool to home.
	Battery is defective	Replace battery

**Reset tool to home: quickly pull & release the switch*

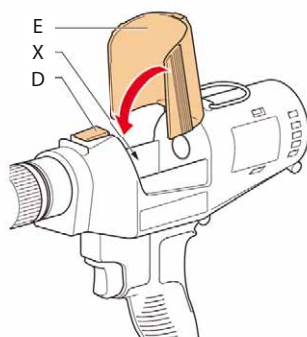

Close the lid (E) of the mandrel collector (X).

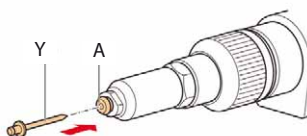

Place the blind rivet (Y) in the nose piece (A).

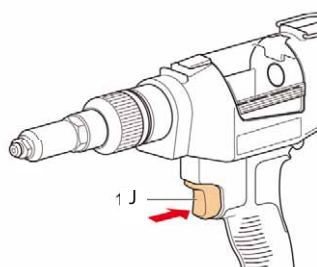

Press and hold the switch (J) until blind rivet is fully set.

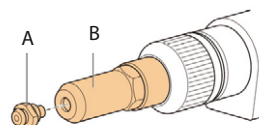

Mount the nose piece (A).

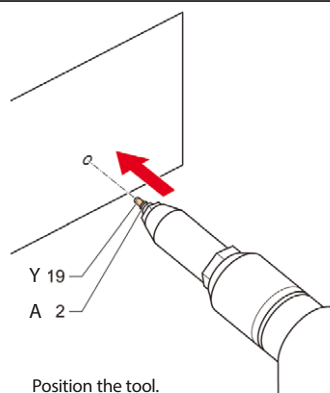

Position the tool.



Holding your world together®

Find your closest STANLEY Engineered Fastening location on
www.StanleyEngineeredFastening.com/contact
For an authorized distributor nearby please check
www.StanleyEngineeredFastening.com/econtact/distributor

Manual Number	Issue	
PB2500-QW	04	

© 2015 Stanley Black & Decker, Inc.

POP® is a registered trade mark of Newfrey LLC. Avdel®, Eurosert®, Avex®, Stavex®, Avinox®, Avibulb®, Interlock®, Klamp-Tite®, Bulbex®, Monobolt®, TLok® and Avseal® are registered trade marks of Avdel UK Limited. The names and logos of other companies mentioned herein may be trademarks of their respective owners. Data shown is subject to change without prior notice as a result of continuous product development and improvement policy. Your local STANLEY Engineered Fastening representative is at your disposal should you need to confirm latest information.