

# ARCONIC

Innovation, engineered.

## Instruction Manual

### SF46-250-02

BobTail® Hydraulic Installation Tool



**Declaration of Conformity**  
2

**Safety Instructions**  
3-4

**Sticker Locations**  
4

**Specifications**  
5

**Principle of Operation**  
6

**Preparation for Use**  
6

**Tool-to-Powerig® Setup**  
7

**Pressure Settings**  
7

**Optional Equipment**  
7

**Operating Instructions**  
8

**Assembly of NPTF  
Threaded Components**  
8

**Maintenance**  
9

**Sticker Locations**  
9

**Components Drawing**  
10

**Nose Assembly Installation  
and Removal Procedures**  
11

**Tool Disassembly and  
Assembly Procedures**  
12

April 26, 2019  
**HK1213**

Makers of Huck®, Marson®, Recoil®  
Brand Fasteners, Tools & Accessories

**ARCONIC**

## EC Declaration of Conformity

### Manufacturer:

Huck International, LLC, Industrial Products Group, 1 Corporate Drive, Kingston, NY, 12401, USA

### Description of Machinery:

Models SF## families of hydraulic installation tools and specials based on their design (e.g. PR####).

### Relevant provisions complied with:

Council Directive related to Machinery (2006/42/EC)

British Standard related to hand held, non-electric power tools (ISO 11148-1:2011)

### European Representative:

Rob Pattenden, Huck International, Ltd. Unit C Stafford Park 7, Telford Shropshire TF3 3BQ, England, United Kingdom

### Authorized Signature/date:

I, the undersigned, do hereby declare that the equipment specified above conforms to the above Directive(s) and Standard(s).

Signature: \_\_\_\_\_

Full Name: Robert B. Wilcox

Position: Engineering Manager

Location: Huck International, LLC d/b/a Arconic Fastening Systems and Rings  
Kingston, New York, USA

Date: 01/11/2016 (November 1, 2016)



### Declared dual number noise emission values in accordance with ISO 4871

A weighted sound power level, LWA: **76** dB (reference 1 pW) Uncertainty, KWA: 3 dB

A weighted emission sound pressure level at the work station, LpA: **65** dB (reference 20 µPa) Uncertainty, KpA: 3 dB

C-weighted peak emission sound pressure level, LpC, peak: **94** dB (reference 20 µPa) Uncertainty, KpC: 3 dB

Values determined according to noise test code ISO 3744. The sum of a measured noise emission value and its associated uncertainty represents an upper boundary of the range of values which is likely to occur in measurements.

### Declared vibration emission values in accordance with EN 12096

Measured Vibrations emission value, a:	<b>.56</b> m/s <sup>2</sup>
Uncertainty, K:	<b>.31</b> m/s <sup>2</sup>
Values measured and determined according to ISO 28662-1, ISO 5349-2, and EN 1033	

Test data to support the above information is on file at:  
Arconic Fastening Systems and Rings, Kingston Operations, Kingston, NY, USA.





## Safety Instructions

### GLOSSARY OF TERMS AND SYMBOLS:

 Product complies with requirements set forth by the relevant European directives.

 Read manual prior to using this equipment.

 Eye protection is required while using this equipment.

 Hearing protection is required while using this equipment.

Notes: are reminders of required procedures.

***Bold, Italic type, and underline:*** emphasize a specific instruction.

 **WARNINGS: Must be understood to avoid severe personal injury.**

 **CAUTIONS: Show conditions that will damage equipment or structure.**

### I. GENERAL SAFETY RULES:

1. A half hour long hands-on training session with qualified personnel is recommended before using Huck equipment.
2. Huck equipment must be maintained in a safe working condition at all times. Tools and hoses should be inspected at the beginning of each shift/day for damage or wear. Any repair should be done by a qualified repairman trained on Huck procedures.
3. For multiple hazards, read and understand the safety instructions before installing, operating, repairing, maintaining, changing accessories on, or working near the assembly power tool. Failure to do so can result in serious bodily injury.
4. Only qualified and trained operators should install, adjust or use the assembly power tool.
5. Do not modify this assembly power tool. This can reduce effectiveness of safety measures and increase operator risk.
6. Do not discard safety instructions; give them to the operator.
7. Do not use assembly power tool if it has been damaged.
8. Tools shall be inspected periodically to verify all ratings and markings required, and listed in the manual, are legibly marked on the tool. The employer/operator shall contact the manufacturer to obtain replacement marking labels when necessary. Refer to assembly drawing and parts list for replacement.
9. Tool is only to be used as stated in this manual. Any other use is prohibited.
10. Read MSDS Specifications before servicing the tool. MSDS specifications are available from the product manufacturer or your Huck representative.
11. Only genuine Huck parts shall be used for replacements or spares. Use of any other parts can result in tooling damage or personal injury.
12. Never remove any safety guards or pintail deflectors.
13. Never install a fastener in free air. Personal injury from fastener ejecting may occur.
14. Where applicable, always clear spent pintail out of nose

assembly before installing the next fastener.

15. Check clearance between trigger and work piece to ensure there is no pinch point when tool is activated. Remote triggers are available for hydraulic tooling if pinch point is unavoidable.
16. Do not abuse tool by dropping or using it as a hammer. Never use hydraulic or air lines as a handle or to bend or pry the tool. Reasonable care of installation tools by operators is an important factor in maintaining tool efficiency, eliminating downtime, and preventing an accident which may cause severe personal injury.
17. Never place hands between nose assembly and work piece. Keep hands clear from front of tool.
18. Tools with ejector rods should never be cycled with out nose assembly installed.
19. When two piece lock bolts are being used always make sure the collar orientation is correct. See fastener data sheet for correct positioning.

### II. PROJECTILE HAZARDS:

1. Risk of whipping compressed air hose if tool is pneudraulic or pneumatic.
2. Disconnect the assembly power tool from energy source when changing inserted tools or accessories.
3. Be aware that failure of the workpiece, accessories, or the inserted tool itself can generate high velocity projectiles.
4. Always wear impact resistant eye protection during tool operation. The grade of protection required should be assessed for each use.
5. The risk of others should also be assessed at this time.
6. Ensure that the workpiece is securely fixed.
7. Check that the means of protection from ejection of fastener or pintail is in place and operative.
8. There is possibility of forcible ejection of pintails or spent mandrels from front of tool.

### III. OPERATING HAZARDS:

1. Use of tool can expose the operator's hands to hazards including: crushing, impacts, cuts, abrasions and heat. Wear suitable gloves to protect hands.
2. Operators and maintenance personnel shall be physically able to handle the bulk, weight and power of the tool.
3. Hold the tool correctly and be ready to counteract normal or sudden movements with both hands available.
4. Maintain a balanced body position and secure footing.
5. Release trigger or stop start device in case of interruption of energy supply.
6. Use only fluids and lubricants recommended by the manufacturer.
7. Avoid unsuitable postures, as it is likely for these not to allow counteracting of normal or unexpected tool movement.
8. If the assembly power tool is fixed to a suspension device, make sure that fixation is secure.
9. Beware of the risk of crushing or pinching if nose equipment is not fitted.

Continued on next page...



## Safety Instructions (continued)

### IV. REPETITIVE MOTION HAZARDS:

1. When using assembly power tool, the operator can experience discomfort in the hands, arms, shoulders, neck or other parts of the body.
2. When using tool, the operator should adopt a comfortable posture while maintaining a secure footing and avoid awkward or off balanced postures.
3. The operator should change posture during extended tasks to help avoid discomfort and fatigue.
4. If the operator experiences symptoms such as persistent or recurring discomfort, pain, throbbing, aching, tingling, numbness, burning sensations or stiffness, these warnings should not be ignored. The operator should tell the employer and consult a qualified health professional.

### V. ACCESSORIES HAZARDS:

1. Disconnect tool from energy supply before changing inserted tool or accessory.
2. Use only sizes and types of accessories and consumables that are recommended. Do not use other types or sizes of accessories or consumables.

### VI. WORKPLACE HAZARDS:

1. Be aware of slippery surfaces caused by use of the tool and of trip hazards caused by the air line or hydraulic hose.
2. Proceed with caution while in unfamiliar surroundings; there could be hidden hazards such as electricity or other utility lines.
3. The assembly power tool is not intended for use in potentially explosive environments.
4. Tool is not insulated against contact with electrical power.
5. Ensure there are no electrical cables, gas pipes, etc., which can cause a hazard if damaged by use of the tool.

### VII. NOISE HAZARDS:

1. Exposure to high noise levels can cause permanent, disabling hearing loss and other problems such as tinnitus, therefore risk assessment and the implementation of proper controls is essential.
2. Appropriate controls to reduce the risk may include actions such as damping materials to prevent workpiece from 'ringing'.
3. Use hearing protection in accordance with employer's

instructions and as required by occupational health and safety regulations.

4. Operate and maintain tool as recommended in the instruction handbook to prevent an unnecessary increase in the noise level.
5. Select, maintain and replace the consumable / inserted tool as recommended to prevent an unnecessary increase in noise.
6. If the power tool has a silencer, always ensure that it is in place and in good working order when the tool is being operated.

### VIII. VIBRATION HAZARDS:

1. Exposure to vibration can cause disabling damage to the nerves and blood supply to the hands and arms.
2. Wear warm clothing when working in cold conditions and keep hands warm and dry.
3. If numbness, tingling, pain or whitening of the skin in the fingers or hands, stop using the tool, tell your employer and consult a physician.
4. Support the weight of the tool in a stand, tensioner or balancer in order to have a lighter grip on the tool.

### X. HYDRAULIC TOOL SAFETY INSTRUCTIONS:



#### WARNINGS:

**Do not exceed maximum pull or return settings on tool.**

**Be sure all hose connections are tight. All tool hoses must be connected.**

1. Carry out a daily check for damaged or worn hoses or hydraulic connections and replace if necessary.
2. Wipe all couplers clean before connecting. Failure to do so can result in damage to the quick couplers and cause overheating.
3. Ensure that couplings are clean and correctly engaged before operation.
4. Use only clean oil and filling equipment.
5. Power units require a free flow of air for cooling purposes and should therefore be positioned in a well ventilated area free from hazardous fumes.
6. Do not inspect or clean the tool while the hydraulic power source is connected. Accidental engagement of the tool can cause serious injury.
7. Be sure all hose connections are tight.
8. Wipe all couplers clean before connecting. Failure to do so can result in damage to the quick couplers and cause overheating.



## Specifications

**Power Source:** Huck POWERIG Hydraulic Unit

**Hose Kits:** Use only genuine HUCK Hose Kits rated at 10,000 psi working pressure.

**Hydraulic Fluid:** Hydraulic fluid shall meet DEXRON III, DEXRON VI, MERCON, Allison C-4 or equivalent ATF specifications.

Fire resistant fluid may be used if it is an ester based fluid such as Quintolubric HFD or equivalent. Water based fluid shall NOT be used as serious damage to equipment will occur.

**Max Operating Temp:** 125 ° F (51.7 ° C)

**Max Flow Rate:** 2 gpm (7.57 l/m)

**Max Inlet Pull Pressure:** 8000 psi, (552 bar)

**Max Inlet Return Pressure:** 7000 psi, (483 bar)

**Pull Capacity:** 49,600 lbf (220.6 kN)

**Return Capacity:** 24,900 lbf (110.8 kN)

**Stroke:** 2.50 inches (6.35 cm)

**Weight:** Approximately 17.8 lbs (8.07 kg)

DIMENSION	A	B	Ø C	Ø D	E
Inches (cm)	6.89 (17.5)	4.00 (10.16)	4.00 (10.16)	3.50 (8.89)	2.02 (5.13)

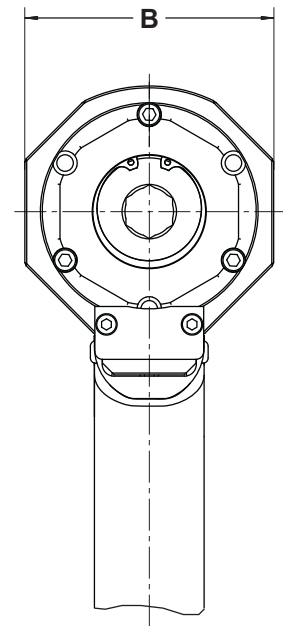
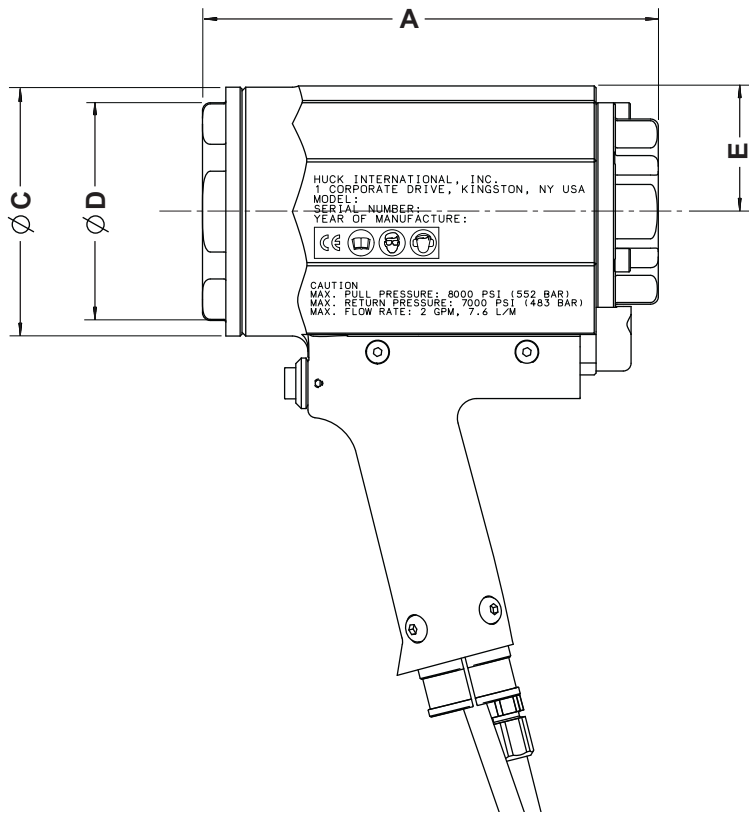

Where the following trade names are used in this manual, please note:

**DEXRON** is a registered trademark of General Motors Corporation.

**GLYD Ring** is a registered trademark of Trelleborg Sealing Solutions Germany GmbH

**Loctite** is a registered trademark of Henkel IP & Holding GmbH

**LUBRIPLATE** is a registered trademark of Fiske Brothers Refining Co.

**MERCON** is a registered trademark of Ford Motor Corp.

**MOLYKOTE** is a registered trademark of Dow Corning Corporation

**Never-Seez** is a registered trademark of Bostik, Inc.

**Quintolubric** is a registered trademark of Quaker Chemical Corp.

**Slic-tite** is a registered trademark of LA-CO Industries, Inc.

**Spirolox** is a registered trademark of Smalley Steel Ring Company

**Teflon** is a registered trademark of Chemours Company FC.

**Threadmate** is a registered trademark of Parker Intangibles LLC.

**TRUARC** is a trademark of TRUARC Co. LLC.

**Vibra-Tite** is a registered trademark of ND Industries, Inc. USA.





## Principle of Operation

The operator pushes the Tool's Nose over the end of the fastener until the Tool's Puller bottoms on the fastener. When the trigger is pressed, the Powerig® receives a signal to swage the fastener. The Piston moves forward to start the swaging process.

After the fastener is fully swaged, the operator must release the trigger, at which point the Tool's Anvil is ejected off of the collar and the Tool is released from the fastener.

## Preparation for Use



### WARNINGS:

Read full manual before using tool.

A half-hour training session with qualified personnel is recommended before using Huck equipment.

When operating Huck installation equipment, always wear approved eye protection.

Be sure there is adequate clearance for the operator's hands before proceeding.

Correct PULL and RETURN pressures are required for operator's safety and for Installation Tool's function. Gauge T-124833CE is available for checking pressures. See Pressure Settings and Gauge Instruction Manual. Failure to verify pressures may result in severe personal injury.

Be sure to connect Tool's hydraulic hoses to Powerig Hydraulic Unit before connecting Tool's switch control cord to unit. If not connected in this order, severe personal injury may occur.

Huck recommends that only Huck Powerig Hydraulic Units be used as a power source for Huck installation equipment. Hydraulic power units that deliver high pressure for both PULL and RETURN, AND ARE NOT EQUIPPED WITH RELIEF VALVES ARE SPECIFICALLY NOT RECOMMENDED AND MAY BE DANGEROUS.



### CAUTIONS:

Do not use TEFLON®\* tape on pipe threads. Pipe threads may cause tape to shred resulting in tool malfunction. (Threadmate™ is available from Huck in a 4oz. tube as part number 508517.)

Do not let disconnected hoses and couplers contact a dirty floor. Keep harmful material out of hydraulic fluid. Dirt in hydraulic fluid causes valve failure in Tool and In Powerig Hydraulic Unit.

Hose couplers must be completely joined together to insure that ball checks in both nipple and body are completely open. Improperly assembled couplers will cause overheating and malfunctions in both tool and Powerig. Hand tighten couplers. Do NOT use a pipe wrench.

### POWER SOURCE CONNECTIONS

1. Coat hose fitting threads with a non-hardening TEFLON® thread compound such as Threadmate™, available from Huck in a 4oz. tube as p/n 508517.
2. Attach proper Nose Components to Tool as applicable.
3. Use Huck Powerig® Hydraulic Unit, or equivalent, that has been prepared for operation per instruction

manual. Check PULL and RETURN pressures and, if required, adjust to pressures given in PRESSURE SETTINGS section of this manual.

4. First, turn hydraulic unit to OFF. Then disconnect power supply from hydraulic unit. Disconnect trigger control system from hydraulic unit.
5. Connect PULL pressure hose, with coupler nipple, into port "P" of tool. Use only with HUCK supplied hoses rated at 10,000 psi or greater. Check trigger assembly for apparent damage or wear. If required, adjust position of trigger assembly on hose. Connect trigger control system to hydraulic unit.
6. Connect hydraulic unit to power supply (air or electric). Turn hydraulic unit to ON. Depress trigger a few times to cycle tool and to circulate hydraulic fluid. Observe action of Tool and check for leaks.

### HYDRAULIC COUPLINGS

**Figure 2**

504438 O-ring 501102 Back-up Ring

**110439  
Female  
Connector**

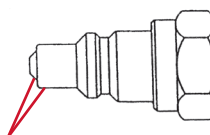
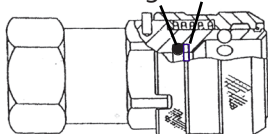

**110438  
Male  
Connector**

Use a fine India stone to remove any nicks or burrs from these areas to prevent damage to O-ring of Female Connector.



## Tool to Powerig Setup

**WARNINGS:**

To prevent tripping hazard, suspend tools and route hoses off of floors.

Only use compatible equipment with this tool.

1. Set Pull and Return pressures on Powerig using Huck Gage P/N: T-124833CE and **Table 1** below.
2. Connect Hydraulic Hoses to the Powerig.
3. Connect other end of Hose Assembly to the Tool.
4. Connect Power Cord from Tool to the Hose Assembly.
5. Connect Power Cord from the Hose Assembly to the Powerig.
6. Once the system is set up, turn Powerig and install test fastener. Check to be sure fastener is installed correctly. This can be checked by using the appropriate swage gauge.

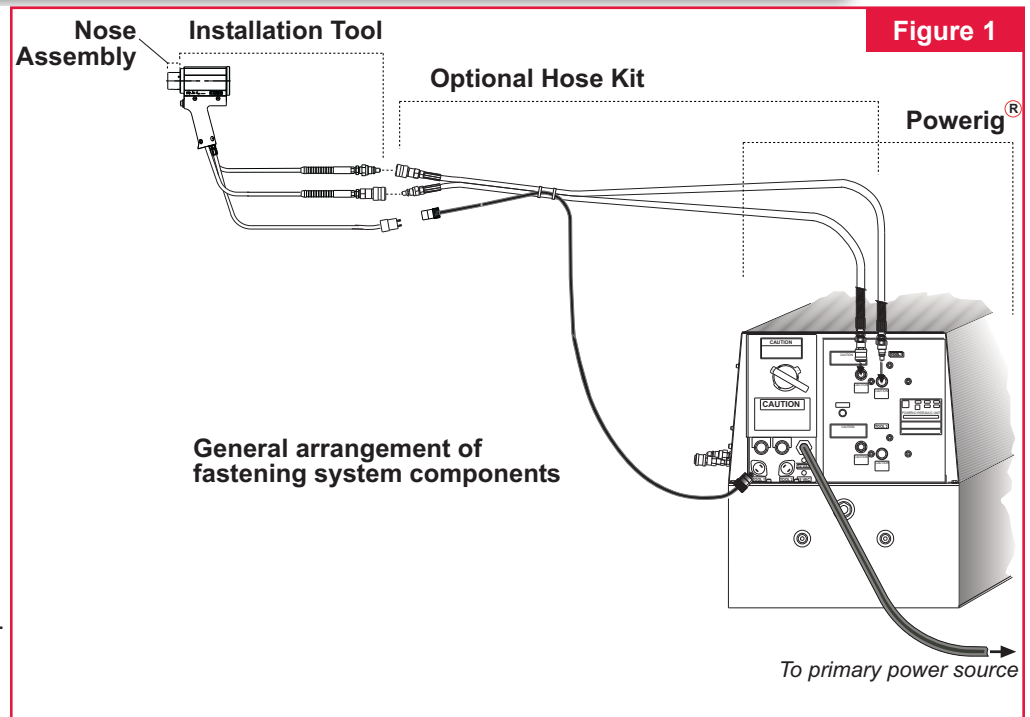

## Pressure Settings

**Notes:**

1. All pressures shown in Table 1 are starting points. Pressures may need to be adjusted up or down due to application and tooling setup.
2. Pressures shown are for both installation and removal applications.

**Table 1**

Fastener Size	Grade 5 Pull (psi)	Grade 5 Return (psi)	Grade 8 Pull (psi)	Grade 8 Return (psi)	Class 8.8 Pull (psi)	Class 8.8 Return (psi)	Class 10.9 Pull (psi)	Class 10.9 Return (psi)
-24 (3/4")	3400	2000	5200	2800	-	-	-	-
20mm	-	-	-	-	3400	2000	6400	2850
-28 (7/8")	4300	2900	-	-	-	-	-	-
-32 (1")	5500	3200	7400	4300	-	-	-	-

## Optional Equipment

TEFLON® Stick	-	503237
TEFLON® Sealant	-	620012
Loctite® 243	-	508567
Never-Seez® NS-160	-	505565
(anti-seize and lubricating compound)		
LUBRIPLATE® 130-AA	-	502723
Threadmate™ (4oz. tube)	-	508517
Pressure Gauge	-	T-124833CE
Service Kit	-	SF46KIT
Swage Gage	-	HG-S-MBT20 (20mm)
		HG-S-BT24 (3/4")

Puller Wrench	-	128817
(Used to tighten and loosen nose assembly locknut)		
Hose Assembly	<u>HOSE LENGTH</u>	<u>PART NO.</u>
(Contains 2 identical	-	6 ft
hydraulic hoses with	-	12 ft
one male and one female	-	26 ft
quick connect fitting at	-	38 ft
each end)	-	52 ft



## Operating Instructions

FOR SAFE OPERATION, THIS SECTION MUST BE READ AND UNDERSTOOD.

Figure 3

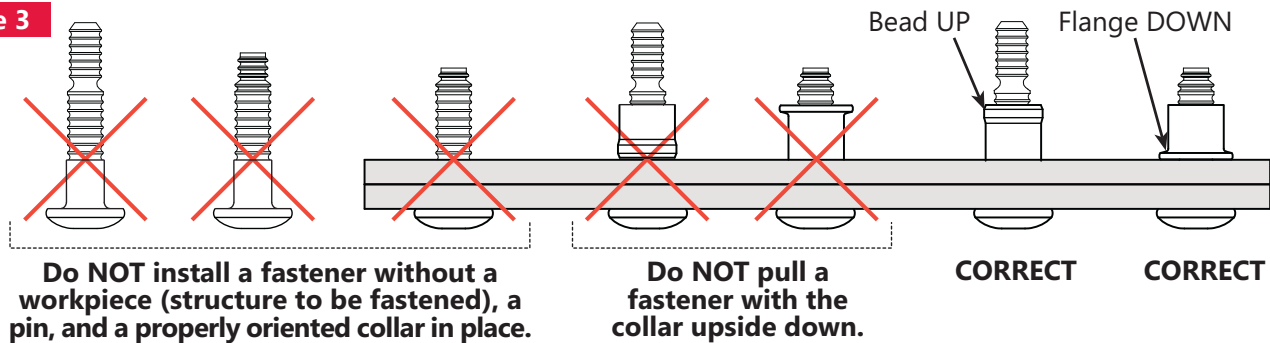

### WARNINGS:

To avoid severe personal injury, wear approved eye and ear protection.

Be sure of adequate clearance for operator's hands before proceeding with fastener installation.

Do NOT attempt to install a pin without placing the fastener and collar in the work piece (structure to be fastened).

Do NOT attempt to install a pin without a properly oriented collar in place.

The collar flange must be against work piece.

If these safety measures are not followed, the fastener could eject with great velocity and cause severe personal injury.

This condition can cause pin to eject with great velocity and force if the pintail breaks off or teeth/grooves strip. This may cause severe personal injury.

To avoid pinch point, never place hand between nose assembly and work piece.

Only use compatible equipment with this tool.



### CAUTIONS: Remove

excess gap from between the sheets. This permits enough pintail to emerge from collar for ALL jaw teeth to engage with pintail. If ALL teeth do not engage properly, jaws will be damaged.

**Note:** In certain situations, it may be permissible to use a BobTail tool and fastener without a collar to remove sheet gap prior to full installation with a collar. Consult qualified Huck engineering personnel before attempting this operation.

### GENERAL

Operators should receive training from qualified personnel. Do not bend tool to free if stuck. Tool should only be used to install fasteners. NEVER use as a jack/spreader or hammer.

### TO INSTALL A BobTail® FASTENER:

1. Check work and remove excessive gap. (Gap is the space between sheets. Gap is excessive if not enough pintail sticks through the collar for the nose assembly puller to grab onto).
2. Put BobTail pin in hole.

3. Slide BobTail collar over pin. (The flanged end of the collar must be towards the pieces being fastened.)
4. Push nose assembly onto the pin until the nose assembly puller stops against the pin. Tool and nose assembly must be held at right angles (90 degrees) to the work.
5. Depress tool trigger to start installation cycle.
6. When forward motion of nose assembly anvil stops, release trigger. Tool will go into its return stroke and push off the installed fastener.
7. The tool and nose assembly are ready for the next installation cycle.

## Assembly of NPTF Threaded Components

### AIR FITTINGS

- 1) Apply TEFLON® stick to male threads which do not have pre-applied sealant per manufacturer's recommendations. (Proceed to All Fittings step 2)

### HYDRAULIC FITTINGS

- 1) Apply Threadmate™ to male and female threads which do not have pre-applied sealant per manufacturer's recommendations. (Proceed to All Fittings step 2)

### ALL FITTINGS:

- 2) Tighten to finger-tight condition.
- 3) Wrench tighten to 2-3 turns past finger-tight condition.

- 4) Final thread engagement can be checked (optional) by measuring the dimension from the flange of male fitting to the end of the thread before assembly and subtracting the distance under the flange after assembly.

Thread Size	Final thread engagement at full make-up
1/8-27 NPTF	.235 inch (.59 cm)
1/4-18 NPTF	.339 inch (.86 cm)
3/8-18 NPTF	.351 inch (.89 cm)





## Maintenance



**WARNING:** Inspect tool for damage or wear before each use. Do not operate if damaged or worn, as severe personal injury may occur.



### CAUTIONS:

Consult MSDS before servicing tool.

Keep dirt and other material out of hydraulic system.

Separated parts must be kept away from dirty work surfaces.

Dirt/debris in hydraulic fluid causes failure in Powerig® Hydraulic Unit valves.

Do not use TEFLON® tape on pipe threads. Pipe threads may cause tape to shred resulting in tool malfunction. (Threadmate™ is available from Huck in a 4oz. tube as part number 508517.)

Always replace seals, wipers, and back-up rings when tool is disassembled for any reason.

The efficiency and life of your tool depends on proper maintenance. Please read this section completely before proceeding with maintenance and repair. Use proper hand tools in a clean and well-lighted area. Only standard hand tools are required in most cases. Where a special tool is required, the description and part number are given. When clamping tool or parts in a vise, and when parts require force, use suitable soft materials to cushion impact. For example, using a half-inch brass drift, wood block and vise with soft jaws greatly reduces possibility of damaging tool. Remove components in a straight line without bending, cocking or undue force. Reassemble tool with the same care.

### Sealants, Lubricants, Service Kits

See SPECIFICATIONS for fluid type. Dispose of fluid in accordance with local environmental regulations. Recycle steel, aluminum, and plastic parts in accordance with local lawful and safe practices. Rub pipe plug threads and quick connect fittings with PTFE thread compound. Smear LUBRIPLATE® 130AA, or equivalent lubricant, on O-Rings and mating surfaces to aid assembly and to prevent damage to O-Rings. (LUBRIPLATE 130-AA is available in

a tube as Huck P/N 502723.) Each Service Kit contains perishable parts for your specific tool. As foreseeable use may indicate, keep extra kits (O-rings, Back-up Rings, other standard items) and tool parts in stock. When stock is depleted, order kits from a regular retailer of these items.

### PREVENTIVE MAINTENANCE

#### System Inspection

Operating efficiency of the tool is directly related to the performance of the complete system, including the tool with nose assembly, hydraulic hoses, trigger and control cord, and Powerig. Therefore, an effective preventive maintenance program includes scheduled inspections of the system to detect and correct minor troubles. At the beginning of each shift/day:

- Inspect tool and nose assembly for external damage.
- Verify that hydraulic hose fittings, couplings, and electrical connections are secure.
- Inspect hydraulic hoses for damage and deterioration. Do not use hoses to carry tool. Replace hoses if damaged.
- Observe tool, hoses, and hydraulic unit during operation to detect abnormal heating, leaks, or vibration.
- Max hydraulic fluid contamination level: NAS 1638 class 9, or ISO CODE 18/15, or SAE level 6.

#### Powerig Maintenance

Maintenance instructions and repair procedures are in the appropriate Powerig Instruction Manual.

#### Tool Maintenance

Whenever disassembled and also at regular intervals (depending on severity and length of use), replace all seals, wipers, and back-up rings in tool. Service Kits, hoses, and extra parts should be kept in stock. Inspect cylinder bore, pistons, and piston rods for scored surfaces and excessive wear or damage. Replace as necessary.

#### Nose Assembly Maintenance

Clean nose assembly often. Dip in mineral spirits or similar solvent to clean puller and wash away metal chips and debris. At regular intervals, as experience shows, disassemble nose and use a sharp "pick" to remove embedded particles from grooves of puller.

## Sticker Locations

HUCK hydraulic tools come labeled with stickers which contain safety and pressure settings information. Stickers must remain on the tool and readable. If a sticker becomes damaged or worn, or if it has been removed from the tool, or when replacing the hydraulic Cylinder, it must be ordered and placed in the location shown on Tool Components Drawing, page 12.

Figure 4

590517  
HUCK/Year of  
Manufacture  
Sticker



590512-9  
CE and WARNING  
Sticker

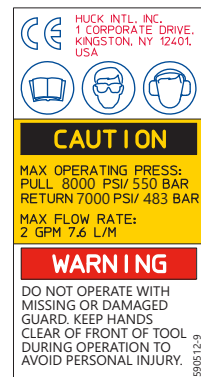

590512-9\_revB





## Nose Assembly Installation and Removal

### ASSEMBLY PROCEDURE:

Preparation: Remove retaining ring, cap screws, plug cover, lock screw, and puller holder retainer.

1. a. **For installation noses and 3/4" and 20 mm cutter puller:**

Using V-jaw locking pliers, ensure the puller head is closed tightly; then slide puller head in from rear of cylinder. Release locking pliers, and tap puller the rest of the way through with a mallet. (Figures 6, 7, & 8)

- b. **For cutter noses for 7/8" and larger, which will not fit through the puller holder:**

Slide the piston through the anvil from the front of the tool and secure in place by screwing on the puller retainer.

2. Replace puller holder retainer, lock screw, cap screws and retaining ring.
3. Thread anvil into piston.

### NOSE ASSEMBLY REMOVAL (Figure 5)

1. Turn anvil with wrench on flats or spanner wrench, as required. (RH thread)
2. Remove retaining ring from back of tool.
3. Pull anvil off.
4. Use 7/8 hex wrench to remove lock screw from puller holder. (RH thread)
5. Remove cap screws, NPT plug cover and puller holder retainer.
6. a. **For installation noses and 3/4" and 20 mm cutter puller:**

Using a soft drift and a mallet, push the puller through the rear of the tool and out.

- b. **For cutter noses for 7/8" and larger, which will not fit through the puller holder:**

Push the puller rearward through the tool until the puller retainer is exposed. Unscrew (RH thread) and remove puller retainer. Then push puller out through the front of the tool.

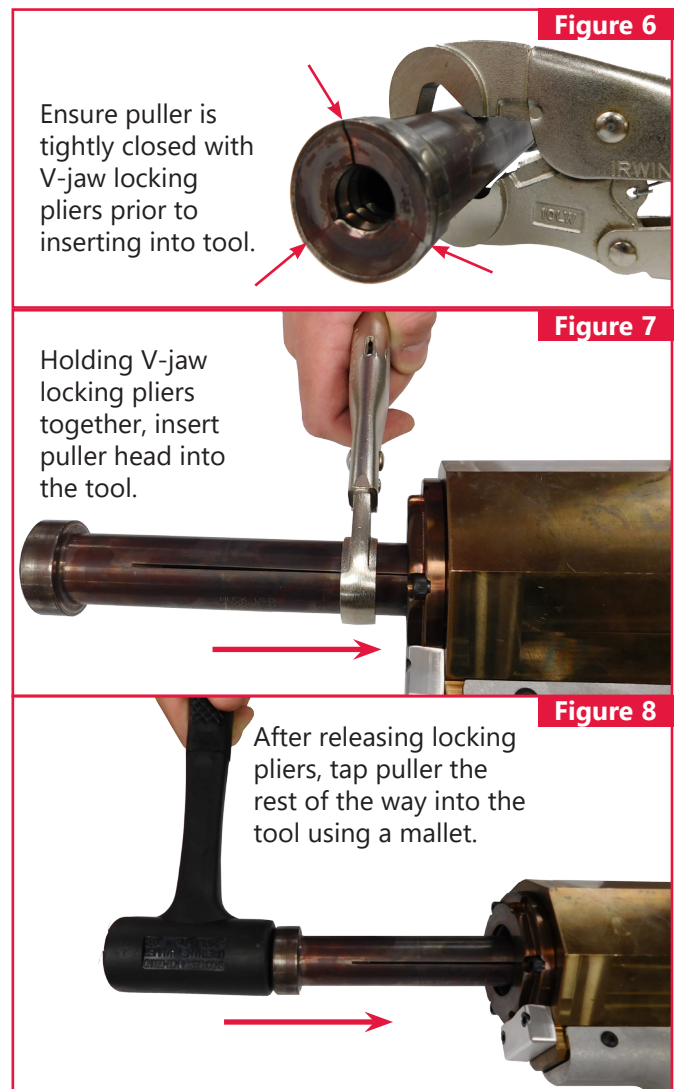
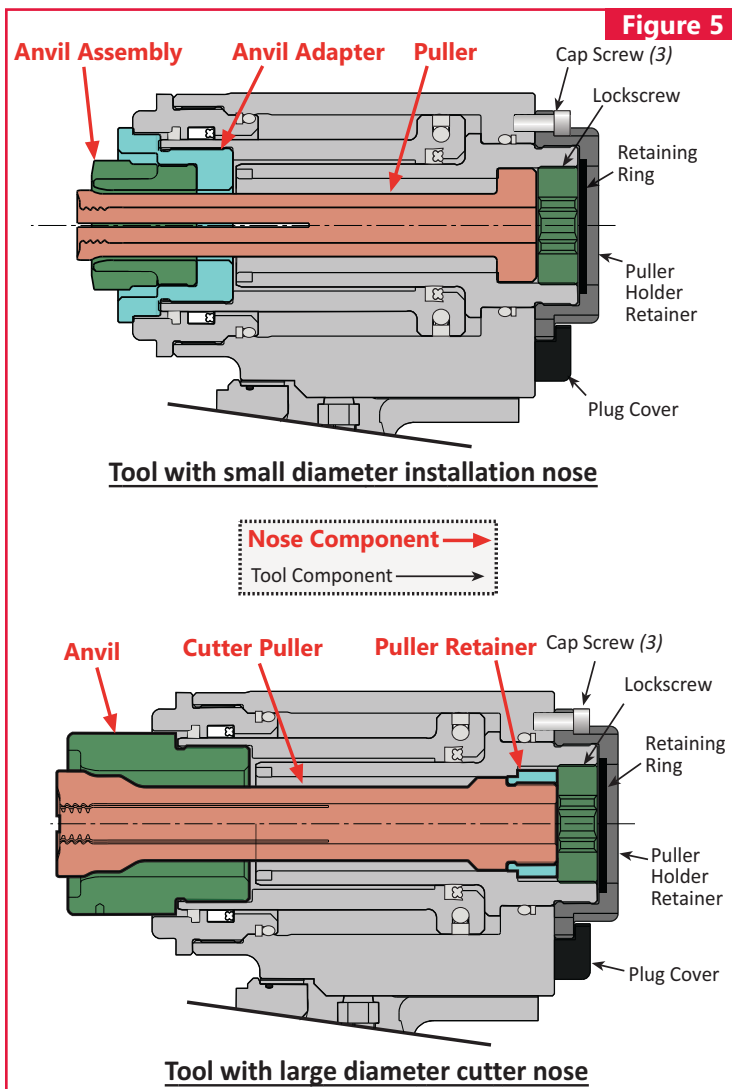



## Tool Disassembly Procedure



**WARNING:** Be sure to disconnect tool electrical control trigger system from Powerig® Hydraulic Unit **BEFORE** disconnecting tool's hydraulic hoses from unit. If not disconnected in this order, severe personal injury may occur.

Disassemble only the components necessary to check damaged O-ring, wiper, back-up ring, piston seal, or other components.

1. Disconnect electrical control cord from powerig.
2. Uncouple tool's hydraulic hoses from powerig.
3. Remove nose assembly from tool (refer to **Nose Assembly Removal** section below).
4. Using 3.25 inch wrench, unthread Gland fully and remove.
5. Pull piston out of cylinder assembly from front of tool.
6. Remove 2 capscrews and NPT plug cover.
7. Remove locking pin.

8. Push puller holder out of cylinder from back of tool.
9. Using a small diameter, dull-pointed rod, remove O-ring, back-up rings, wiper, piston seal, and polyseals.

## Tool Assembly Procedure



**WARNINGS:**  
Do not omit any seals during servicing, leaks will result and personal injury may occur.

**Tool must be fully assembled with all components included.**



**CAUTION:** Do not use TEFLON tape.

### ASSEMBLY PREPARATION:

- (a) Clean components in mineral spirits or other solvent compatible with O-ring seals.
- (b) Clean out O-ring grooves.
- (c) Inspect components for scoring, excessive wear or damage.
- (d) Replace O-rings and back-up rings. Be sure that relative positions of the O-rings and back-up rings are as shown in assembly drawing.
- (e) Service Kit part number SF46KIT contains O-Rings, Back-up Rings and other seals necessary for servicing this tool.
- (f) Smear Lubriplate 130AA on O-rings and mating surfaces to prevent damage to O-rings and to aid assembly.

### ASSEMBLY PROCEDURE (TOOL HEAD ONLY)(FIGURE 4):

1. Install O-ring and back-up ring in cylinder.
  2. Install piston seal and polyseal on piston. Note orientation of polyseal.
  3. Slide assembled piston over puller holder, and insert them into cylinder assembly.
  4. Thread puller holder retainer on to puller holder, then back off until cap screw holes are aligned, and install 3 cap screws.
  5. Install O-ring, back-up ring, wiper, and polyseal (note orientation of seals in Figure 4), on gland.
  6. Apply Threadmate™ compound to threads of gland, and screw gland into cylinder.
- Note: Threadmate is available from Huck in a 4oz. tube as part number 508517.**
7. Connect tool hoses to powerig hoses.
  8. Connect tool electrical trigger plug to powerig, and cycle tool a few times. Observe action of tool and check for leaks.
  9. Disconnect tool electrical trigger plug, then tool hoses, from powerig.
  10. Attach nose assembly to tool following instructions as described below.



## Limited Warranties

### Limited Lifetime Warranty on BobTail® Tools:

Huck International, Inc. warrants to the original purchaser that its BobTail® installation tools manufactured after 12/1/2016 shall be free from defects in materials and workmanship for its **useful lifetime**. This warranty does not cover special order / non-standard products, or part failure due to normal wear, tool abuse or misapplication, or user non-compliance with the service requirements and conditions detailed in the product literature.

### Two Year Limited Warranty on Installation Tools:

Huck International, Inc. warrants that its installation tools and Powerig® hydraulic power sources manufactured after December 1, 2016 shall be free from defects in materials and workmanship for a period of two years from date of purchase by the end user. This warranty does not cover special order / non-standard products, or part failure due to normal wear, tool abuse or misapplication, or user non-compliance with the service requirements and conditions detailed in the product literature.

### 90 Day Limited Warranty on Nose Assemblies and Accessories:

Huck International, Inc. warrants that its nose assemblies and accessories shall be free from defects in materials and workmanship for a period of 90 days from date of purchase by the end user. This warranty does not cover special clearance noses, or special order / non-standard product, or part failure due to normal wear, abuse or misapplication, or user non-compliance with the service requirements and conditions detailed in the product literature.

**Useful lifetime** is defined as the period over which the product is expected to last physically, up to the point when replacement is required due to either normal in-service wear, or as part of a complete overhaul. Determination is made on a case-by case basis upon return of parts to Huck International, Inc. for evaluation.

### Tooling, Part(s) and Other Items not manufactured by Huck:

HUCK makes no warranty with respect to the tooling, part(s), or other items manufactured by third parties. HUCK expressly disclaims any warranty expressed or implied, as to the condition, design, operation, merchantability, or fitness for use of any tool, part(s), or other items thereof not manufactured by HUCK. HUCK shall not be liable for any loss or damage, directly or indirectly, arising from the use of such tooling, part(s), or other items or breach of warranty or for any claim for incidental or consequential damages.

Huck shall not be liable for any loss or damage resulting from delays or non-fulfillment of orders owing to strikes, fires, accidents, transportation companies or for any reason or reasons beyond the control of the Huck or its suppliers.

### Huck Installation Equipment:

Huck International, Inc. reserves the right to make changes in specifications and design and to discontinue models without notice.

Huck Installation Equipment should be serviced by trained service technicians only.

Always give the serial number of the equipment when corresponding or ordering service parts.

Complete repair facilities are maintained by Huck International, Inc. Please contact one of the offices listed below.

#### Eastern

One Corporate Drive Kingston, New York 12401-0250  
Telephone (845) 331-7300 FAX (845) 334-7333

#### Outside USA and Canada

Contact your nearest Huck International location (see reverse).

In addition to the above repair facilities, there are Authorized Tool Service Centers (ATSC's) located throughout the United States. These service centers offer repair services, spare parts, Service Parts Kits, Service Tool Kits and Nose Assemblies. Please contact your Huck Representative or the nearest Huck International location (see reverse) for the ATSC in your area.





# ARCONIC

Arconic Inc. (NYSE: ARNC) creates breakthrough products that shape industries. Working in close partnership with our customers, we solve complex engineering challenges to transform the way we fly, drive, build and power.

Through the ingenuity of our people and cutting-edge advanced manufacturing, we deliver these products at a quality and efficiency that ensures customer success and shareholder value.

## Arconic Fastening Systems Tooling Support Locations

### INDUSTRIAL NORTH AMERICA

#### Kingston Operations

1 Corporate Drive  
Kingston, NY 12401  
Tel: +1-800-278-4825  
Fax: +1-845-334-7333  
afs.sales.kingston@arconic.com

#### Tracy Operations (IDG)

1925 North MacArthur Drive  
Tracy, CA 95376  
Tel: +1-800-826-2884  
Fax: +1-800-573-2645  
afs.sales.idg@arconic.com

#### Waco Operations

PO Box 8117  
8001 Imperial Drive  
Waco, TX 76714-8117  
Tel: +1-800-388-4825  
Fax: +1-800-798-4825  
afs.sales.waco@arconic.com

### INDUSTRIAL GLOBAL

#### Kolkata Operations

Unit No. 28, 2nd Floor,  
55/1, Chowringhee Road,  
Kolkata 700071, West Bengal, India  
Tel: +91-33-40699170  
Tel: +91-33-40699180  
Fax: +91-33-40699184

#### Melbourne Operations

1508 Centre Road  
Clayton, Victoria  
Australia 3168  
Tel: +613-8545-3333  
Fax: +613-8545-3390  
afs.sales@arconic.com

#### São Paulo Operations

Rodovia Anhanguera, s/n, KM 17  
Parque São Domingos - Complexo  
Anhanguera - Galpão 1 Seção III  
(Módulo III) Box 11  
CEP 05112-000 São Paulo - SP Brazil  
Tel: +55-11-3583-7061

#### Suzhou Operations

58 Yinsheng Road,  
SIP Suzhou, Jiangsu  
215126 China  
Tel: +86-512-62863800-8888

#### Telford Operations

Unit C, Stafford Park 7  
Telford, Shropshire  
England TF3 3BQ  
Tel: +44-(0)-1952-290011  
Fax: +44-(0)-1952-207701  
thisales@arconic.com

#### Tokyo Operations (Japan and Korea)

1013 Hibiya U-1 Bldg.  
Uchisaiwai-cho 1-1-7  
Chiyoda-ku, Tokyo  
100-0011 Japan  
Tel: +81-3-3539-6594  
Fax: +81-3-3539-6585

### AEROSPACE NORTH AMERICA

#### Kingston Operations

1 Corporate Drive  
Kingston, NY 12401  
Tel: +1-800-278-4825  
Fax: +1-845-334-7333  
afs.sales.kingston@arconic.com

#### Simi Valley Operations

3990A Heritage Oak Court  
Simi Valley, CA 93063  
Tel: +1-805-527-3600  
Fax: +1-805-527-0900  
www.afs-simivalley.com

### AEROSPACE GLOBAL

#### Aichach Operations

Robert-Bosch Str. 4  
Aichach 86551  
Germany  
Tel: +49-8251-8757-0  
aicaafswelcomedl@arconic.com

#### Cergy Operations

15 Rue du Petit Albi  
F-95611 Cergy Pontoise  
France  
Tel: +33-1-34-33-98-00  
Fax: +33-1-34-33-97-77

#### Hong Kong Operations

27th Floor, 88 Hing Fat Street  
Causeway Bay  
Hong Kong, China  
Tel: +852-2864-2012



© 2019 Huck International, Inc.  
**Arconic Fastening Systems**  
**Kingston Operations**  
1 Corporate Drive, Kingston, NY 12401  
Tel: 800-431-3091 • Fax: 845-334-7333  
[www.afshuck.net/us](http://www.afshuck.net/us)



Huck provides technical assistance regarding the use and application of Huck fasteners and tooling. **NOTICE:** The information contained in this publication is only for general guidance with regard to properties of the products shown and/or the means for selecting such products, and is not intended to create any warranty, express, implied, or statutory; all warranties are contained only in Huck's written quotations, acknowledgments, and/or purchase orders. It is recommended that the user secure specific, up-to-date data and information regarding each application and/or use of such products.