

REV	DESCRIPTION	DATE
J	CHUCK JAWS PICTORIALY UPDATED.	02/16/01
K	126688 WAS 122019.	11/13/01

NOTES:

- 1

ANVIL ASSEMBLY P/N 111310 CONSISTS OF:
DRIVING ANVIL P/N 123790
ANVIL HOLDER P/N 111530
(NOT AVAILABLE SEPARATELY).
- 2

ETCH: HUCK UNIMATIC -06
MODEL NO. 99-1035
CHARACTER SIZE TO EQUAL 1/8".
- 3

AFFIX WARNING STICKER P/N 590273 TO
ANVIL HOLDER IN LOCATION SHOWN.

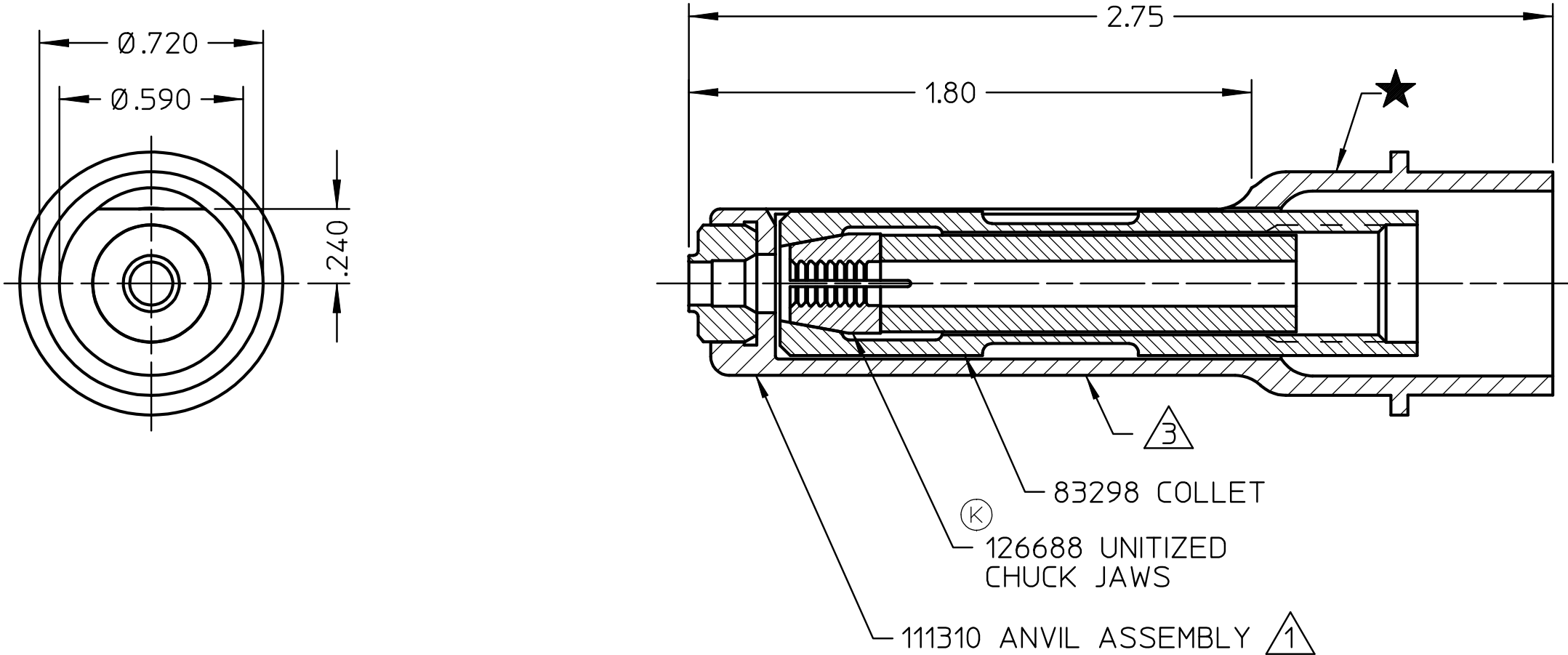

MATERIAL:	-	SPEC: -	TOLERANCES UNLESS OTHERWISE SPECIFIED		HUCK INTERNATIONAL, INC., I.S.D. 85 GRAND STREET, P.O. BOX 2270 KINGSTON, NEW YORK 12401			
HARDNESS:	-							
HEAT TREAT:	-	SPEC: -	.XX, .XXX	±	NOSE ASSEMBLY -06 SMLS			
SURF. TREAT:	-	SPEC: -	INT. COR. RADII					
SURFACE FINISH NOT TO EXCEED		Ra	BREAK EDGES		DET: SMR	CK:	DATE: 08-25-92	SCALE: 2/1
IDENTIFICATION PER SPEC 42-311: ★ NOTE 2			ANGLES	±	FOC.	<div>B</div> <div>99-1035</div>		
SURFACES TO BE ◎, //, ⊕, ⊥, & ▤ WITHIN			T.I.R.	FINAL ASSY: FOR 350 H.I.T.	FAC.			