

**ARCONIC**  
Innovation, engineered.

**Instruction Manual**

**2480 and 2481 series**

**Hydraulic Installation Tools**



November 16, 2018  
**HK970**

**Declaration of Conformity**  
2

**Safety Instructions**  
3-4

**Description**  
5

**Specifications**  
5

**Principle of Operation**  
6

**Tool Setup**  
6

**Preparation for Use**  
7

**Operating Instructions**  
8

**Maintenance**  
9

**Disassembly Procedure**  
10-11

**Assembly Procedure**  
12

**Components Drawings**  
13-16

**Optional Equipment**  
17

**Sticker Locations**  
17

**Troubleshooting**  
18

**ARCONIC**

## EC Declaration of Conformity

### Manufacturer:

Huck International, LLC, Industrial Products Group, 1 Corporate Drive, Kingston, NY, 12401, USA

### Description of Machinery:

Models 2400, 2480, 2500, 2580 family of hydraulic installation tools and specials based on their design (e.g. PR#####).

### Relevant provisions complied with:

Council Directive related to Machinery (2006/42/EC)

British Standard related to hand held, non-electric power tools (ISO 11148-1:2011)

### European Representative:

Rob Pattenden, Huck International, Ltd. Unit C Stafford Park 7, Telford Shropshire TF3 3BQ, England, United Kingdom

### Authorized Signature/date:

I, the undersigned, do hereby declare that the equipment specified above conforms to the above Directive(s) and Standard(s).

Signature:

Full Name: Robert B. Wilcox

Position: Engineering Manager

Location: Huck International, LLC d/b/a Arconic Fastening Systems and Rings  
Kingston, New York, USA

Date: 01/11/2016 (November 1, 2016)



### Declared dual number noise emission values in accordance with ISO 4871

A weighted sound power level, LWA: **85** dB (reference 1 pW) Uncertainty, KWA: 3 dB

A weighted emission sound pressure level at the work station, LpA: **74** dB (reference 20 µPa) Uncertainty, KpA: 3 dB

C-weighted peak emission sound pressure level, LpC, peak: **119** dB (reference 20 µPa) Uncertainty, KpC: 3 dB

Values determined according to noise test code ISO 3744. The sum of a measured noise emission value and its associated uncertainty represents an upper boundary of the range of values which is likely to occur in measurements.

### Declared vibration emission values in accordance with EN 12096

Measured Vibrations emission value, a:

**.20 m/s<sup>2</sup>**

Uncertainty, K:

**.17 m/s<sup>2</sup>**

Values measured and determined according to ISO 28662-1, ISO 5349-2, and EN 1033

Test data to support the above information is on file at:  
Arconic Fastening Systems and Rings, Kingston Operations, Kingston, NY, USA.



# Safety Instructions

## GLOSSARY OF TERMS AND SYMBOLS:



- Product complies with requirements set forth by the relevant European directives.



- **READ MANUAL** prior to using this equipment.



- **EYE PROTECTION IS REQUIRED** while using this equipment.



- **HEARING PROTECTION IS REQUIRED** while using this equipment.



**WARNINGS: must be understood to avoid severe personal injury.**



**CAUTIONS: show conditions that will damage equipment and/or structure.**

**Notes:** are reminders of required procedures.

***Bold, Italic type and underlining:*** emphasizes a specific instruction.

## I. GENERAL SAFETY RULES:

1. A half hour long hands-on training session with qualified personnel is recommended before using Huck equipment.
2. Huck equipment must be maintained in a safe working condition at all times. Tools and hoses should be inspected at the beginning of each shift/day for damage or wear. Any repair should be done by a qualified repairman trained on Huck procedures.
3. For multiple hazards, read and understand the safety instructions before installing, operating, repairing, maintaining, changing accessories on, or working near the assembly power tool. Failure to do so can result in serious bodily injury.
4. Only qualified and trained operators should install, adjust or use the assembly power tool.
5. Do not modify this assembly power tool. This can reduce effectiveness of safety measures and increase operator risk.
6. Do not discard safety instructions; give them to the operator.
7. Do not use assembly power tool if it has been damaged.
8. Tools shall be inspected periodically to verify all ratings and markings required, and listed in the manual, are legibly marked on the tool. The employer/operator shall contact the manufacturer to obtain replacement marking labels when necessary. Refer to assembly drawing and parts list for replacement.
9. Tool is only to be used as stated in this manual. Any other use is prohibited.
10. Read MSDS Specifications before servicing the tool. MSDS specifications are available from the product manufacturer or your Huck representative.
11. Only genuine Huck parts shall be used for replacements or spares. Use of any other parts can result in tooling damage or personal injury.
12. Never remove any safety guards or pintail deflectors.
13. Never install a fastener in free air. Personal injury from fastener ejecting may occur.
14. Where applicable, always clear spent pintail out of nose

assembly before installing the next fastener.

15. Check clearance between trigger and work piece to ensure there is no pinch point when tool is activated. Remote triggers are available for hydraulic tooling if pinch point is unavoidable.
16. Do not abuse tool by dropping or using it as a hammer. Never use hydraulic or air lines as a handle or to bend or pry the tool. Reasonable care of installation tools by operators is an important factor in maintaining tool efficiency, eliminating downtime, and preventing an accident which may cause severe personal injury.
17. Never place hands between nose assembly and work piece. Keep hands clear from front of tool.
18. Tools with ejector rods should never be cycled with out nose assembly installed.
19. When two piece lock bolts are being used always make sure the collar orientation is correct. See fastener data sheet for correct positioning.

## II. PROJECTILE HAZARDS:

1. Risk of whipping compressed air hose if tool is pneudraulic or pneumatic.
2. Disconnect the assembly power tool from energy source when changing inserted tools or accessories.
3. Be aware that failure of the workpiece, accessories, or the inserted tool itself can generate high velocity projectiles.
4. Always wear impact resistant eye protection during tool operation. The grade of protection required should be assessed for each use.
5. The risk of others should also be assessed at this time.
6. Ensure that the workpiece is securely fixed.
7. Check that the means of protection from ejection of fastener or pintail is in place and operative.
8. There is possibility of forcible ejection of pintails or spent mandrels from front of tool.

## III. OPERATING HAZARDS:

1. Use of tool can expose the operator's hands to hazards including: crushing, impacts, cuts, abrasions and heat. Wear suitable gloves to protect hands.
2. Operators and maintenance personnel shall be physically able to handle the bulk, weight and power of the tool.
3. Hold the tool correctly and be ready to counteract normal or sudden movements with both hands available.
4. Maintain a balanced body position and secure footing.
5. Release trigger or stop start device in case of interruption of energy supply.
6. Use only fluids and lubricants recommended by the manufacturer.
7. Avoid unsuitable postures, as it is likely for these not to allow counteracting of normal or unexpected tool movement.
8. If the assembly power tool is fixed to a suspension device, make sure that fixation is secure.
9. Beware of the risk of crushing or pinching if nose equipment is not fitted.

Continued on next page...



## Safety Instructions

### IV. REPETITIVE MOTION HAZARDS:

1. When using assembly power tool, the operator can experience discomfort in the hands, arms, shoulders, neck or other parts of the body.
2. When using tool, the operator should adopt a comfortable posture while maintaining a secure footing and avoid awkward or off balanced postures.
3. The operator should change posture during extended tasks to help avoid discomfort and fatigue.
4. If the operator experiences symptoms such as persistent or recurring discomfort, pain, throbbing, aching, tingling, numbness, burning sensations or stiffness, these warnings should not be ignored. The operator should tell the employer and consult a qualified health professional.

### V. ACCESSORIES HAZARDS:

1. Disconnect tool from energy supply before changing inserted tool or accessory.
2. Use only sizes and types of accessories and consumables that are recommended. Do not use other types or sizes of accessories or consumables.

### VI. WORKPLACE HAZARDS:

1. Be aware of slippery surfaces caused by use of the tool and of trip hazards caused by the air line or hydraulic hose.
2. Proceed with caution while in unfamiliar surroundings; there could be hidden hazards such as electricity or other utility lines.
3. The assembly power tool is not intended for use in potentially explosive environments.
4. Tool is not insulated against contact with electrical power.
5. Ensure there are no electrical cables, gas pipes, etc., which can cause a hazard if damaged by use of the tool.

### VII. NOISE HAZARDS:

1. Exposure to high noise levels can cause permanent, disabling hearing loss and other problems such as tinnitus, therefore risk assessment and the implementation of proper controls is essential.
2. Appropriate controls to reduce the risk may include actions such as damping materials to prevent workpiece from 'ringing'.
3. Use hearing protection in accordance with employer's instructions and as required by occupational health and safety regulations.

4. Operate and maintain tool as recommended in the instruction handbook to prevent an unnecessary increase in the noise level.
5. Select, maintain and replace the consumable / inserted tool as recommended to prevent an unnecessary increase in noise.
6. If the power tool has a silencer, always ensure that it is in place and in good working order when the tool is being operated.

### VIII. VIBRATION HAZARDS:

1. Exposure to vibration can cause disabling damage to the nerves and blood supply to the hands and arms.
2. Wear warm clothing when working in cold conditions and keep hands warm and dry.
3. If numbness, tingling, pain or whitening of the skin in the fingers or hands, stop using the tool, tell your employer and consult a physician.

### X. HYDRAULIC TOOL SAFETY INSTRUCTIONS:



**WARNING: Do not exceed maximum pull or return settings on tool.**

1. Carry out a daily check for damaged or worn hoses or hydraulic connections and replace if necessary.
2. Wipe all couplers clean before connecting. Failure to do so can result in damage to the quick couplers and cause overheating.
3. Ensure that couplings are clean and correctly engaged before operation.
4. Use only clean oil and filling equipment.
5. Power units require a free flow of air for cooling purposes and should therefore be positioned in a well ventilated area free from hazardous fumes.
6. Do not inspect or clean the tool while the hydraulic power source is connected. Accidental engagement of the tool can cause serious injury.
7. Be sure all hose connections are tight.
8. Wipe all couplers clean before connecting. Failure to do so can result in damage to the quick couplers and cause overheating.



## Description

The 2480, A2480, and 2481 series, with appropriate nose assemblies, install a wide range of Huck blind fasteners and HUCKBOLT® fasteners. These lightweight and compact tools are particularly adapted to installing fasteners in limited clearance areas. Each tool is complete with hydraulic hoses and couplings; electric switch and cord. An unloading valve, designed to relieve hydraulic pressure at end of the PULL stroke, is positioned by the piston. The end of the piston rod is threaded, and a retaining nut and stop are included for attaching a nose assembly.

The 2480 series has hoses that pass through the handle, and 2481 has hoses attached to the top of the tool.

Huck Hydraulic Installation Tools are designed to be powered by Huck Powerig® Hydraulic Units, models 913F, 918, 918-5, 940, 968, or equivalent.

A specific nose assembly is required for each fastener type and size. Nose assemblies must be ordered separately by contacting your Huck representative.

## Specifications

**POWER SOURCE:** Huck Powerig® Hydraulic Power Source

**HOSE KITS:** Use only genuine HUCK Hose Kits rated @ 10,000 psi working pressure.

**HYDRAULIC FLUID:**

Hydraulic fluid shall meet DEXRON® III, DEXRON VI, MERCON®, Allison C-4 or equivalent Automatic Transmission Fluid (ATF) specifications. Fire-resistant fluid may be used if it is an ester-based fluid such as Quintolubric® HFD or equivalent. Water-based fluid shall NOT be used as serious damage to equipment will occur.

**MAX OPERATING TEMP:** 125°F (51.7°C)

**MAX FLOW RATE:** 2 gpm (7.5 l/m)

**MAX PULL PRESSURE:** 8400 psi (580 bar)

**MAX RETURN PRESSURE:** 3200 psi (220 bar)

**PULL CAPACITY:** 5380 lbs (24 kN) @ 8400 psi

**STROKE (STANDARD):** .875 inches (22.2 mm)

**STROKE (LS):** 1.250 inches (31.7 mm)

**WEIGHT:** 2.2 lbs (1 kg)

**Where the following trade names are used in this manual, please note:**

**DEXRON** is a registered trademark of General Motors Corporation.

**Loctite** is a registered trademark of Henkel Corporation, U.S.A.

**LUBRIPLATE** is a registered trademark of Fiske Brothers Refining Co.

**MERCON** is a registered trademark of Ford Motor Corp.

**MOLYKOTE** is a registered trademark of Dow Corning Corporation

**Never-Seez** is a registered trademark of Bostik, Inc.

**Quintolubric** is a registered trademark of Quaker Chemical Corp.

**Slic-tite** is a registered trademark of LA-CO Industries, Inc.

**Spirolox** is a registered trademark of Smalley Steel Ring Company

**Teflon** is a registered trademark of E. I. du Pont de Nemours and Company.

**Threadmate** is a registered trademark of Parker Intangibles LLC.

**TRUARC** is a trademark of TRUARC Co. LLC.

**Vibra-Tite** is a registered trademark of ND Industries, Inc. USA.

**Figure 1**

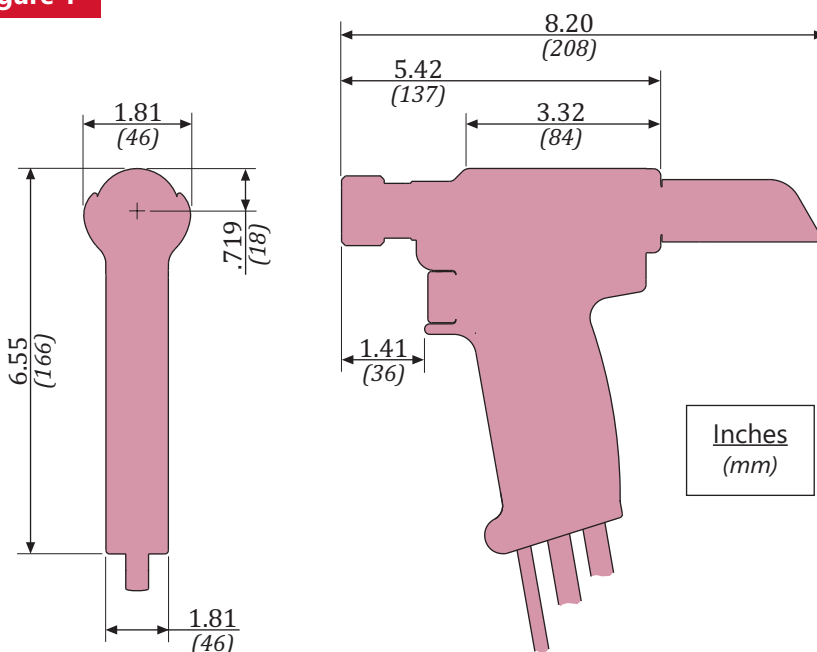





## Principle of Operation

A trigger controls the PULL and RETURN strokes. When the trigger is pressed, hydraulic pressure is directed to PULL side of the piston, and fastener installation begins. At the end of PULL stroke, before the trigger is released, piston uncovers flats of unloading valve, thus unloading pressure by allowing fluid to flow back to Powerig® Hydraulic Unit.

When the trigger is released at end of PULL stroke when fastener is installed, the pressure is directed to RETURN side of the piston and moves piston forward. Nose assembly, with tool, is then pushed off fastener.

## Tool Setup

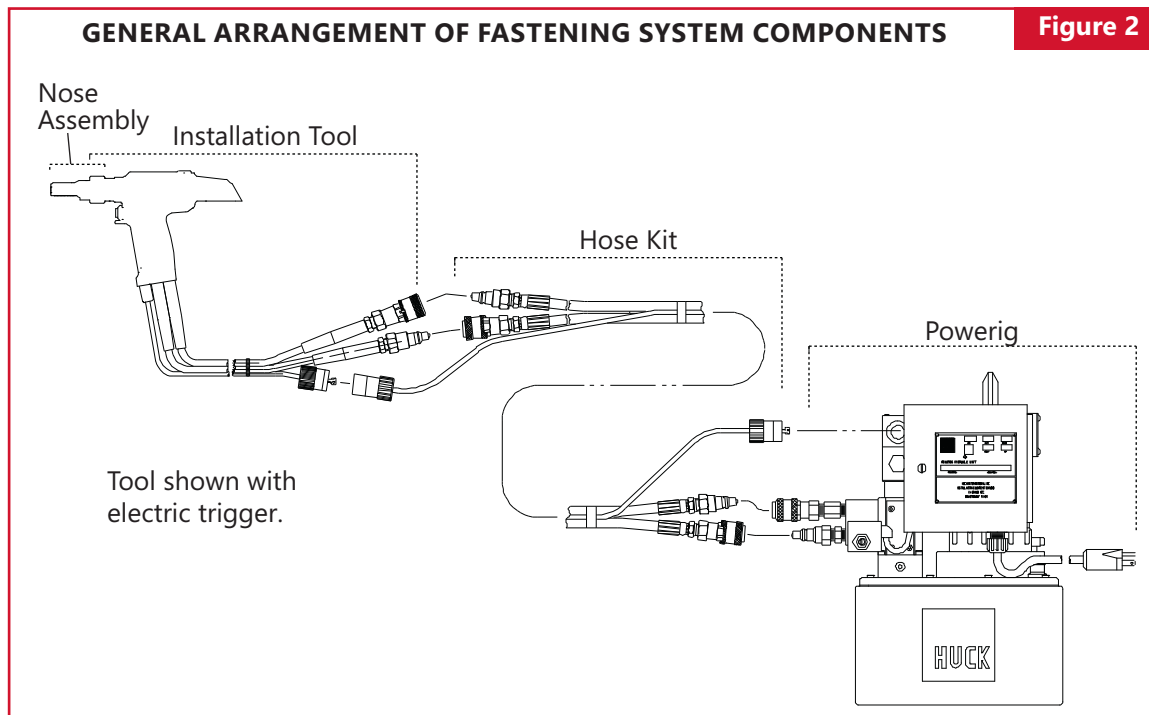

## HEED WARNING AND DANGER ZONE INSTRUCTIONS

**Figure 3**

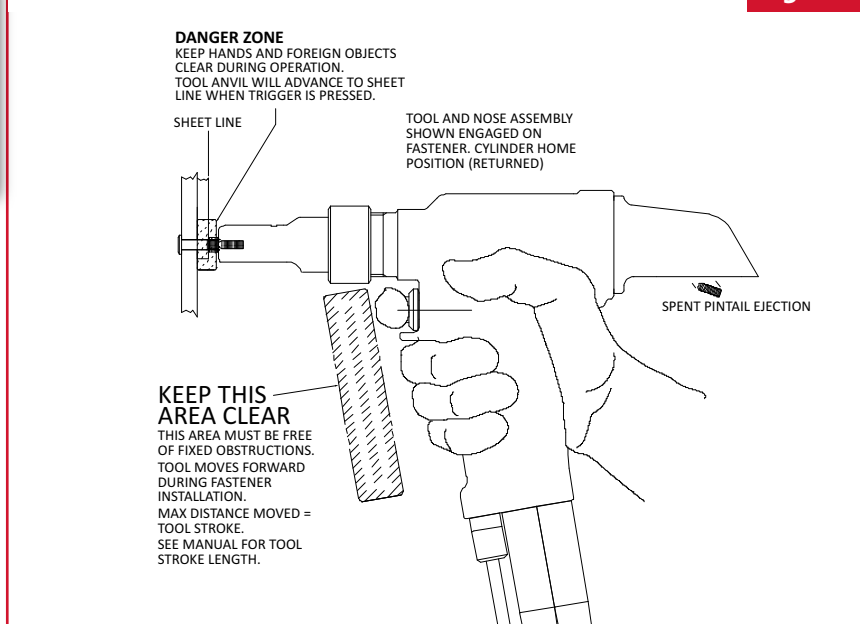



## Preparation for Use

**WARNINGS:**

**Correct PULL and RETURN pressures are required for operator safety and for installation tool function. Gauge p/n T-124883CE is available for checking pressures. See Tool specifications and gauge instruction manual. Failure to verify pressures may result in severe personal injury.**

**Be sure to connect Tool's hydraulic hoses to Powerig® Hydraulic Power Source before connecting Tool's switch control cord to unit. If not connected in this order, severe personal injury may occur.**

**CAUTIONS:**

**Do not let disconnected hoses and couplers contact a dirty floor. Keep harmful material out of hydraulic fluid. Dirt in hydraulic fluid causes valve failure in tool and in Powerig Hydraulic Unit.**

**Do not use TEFLON® tape on pipe threads. Pipe threads may cause tape to shred resulting in tool malfunction. (Slic-Tite is available in stick form as Huck P/N 503237.)**

1. Rub Slic-Tite® TEFLON® thread compound, or equivalent, on pipe threads to prevent leaks and for ease of assembly.
2. Use Huck Powerig® Hydraulic Power Source®, or equivalent, that has been prepared for operation per instruction manual. Check both PULL and RETURN pressures, and ensure they are adjusted to pressures given in SPECIFICATIONS of this manual. See both hydraulic unit instruction manual and T-124883CE instruction manual before and during checking procedure. Visually inspect for leaks and to verify that End Cap is installed correctly.
3. First, turn hydraulic unit to OFF; then disconnect power supply from hydraulic unit. Disconnect trigger control system from hydraulic unit.
4. Connect tool hoses to hydraulic unit. If required, adjust position of trigger assembly on return pressure hose. Connect trigger control system to hydraulic unit.
5. Connect hydraulic unit to power supply (air or electric). Turn hydraulic unit to ON. Hold Tool trigger depressed for 30 seconds; depress trigger a few times to cycle tool and to circulate hydraulic fluid. Observe action of Tool and check for leaks.
6. Select the appropriate nose assembly for the fastener to be installed. Disconnect hydraulic unit from power supply. Disconnect tool's trigger control system from hydraulic unit. Attach nose assembly to tool.
7. Reconnect tool's trigger control system to hydraulic unit; reconnect unit to power supply. Check operation of nose assembly. Install fasteners in test plate of correct thickness with proper size holes. Inspect installed fasteners. If fasteners do not pass inspection, see TROUBLESHOOTING section of this manual to locate and correct malfunction.
8. Operator should receive training on proper use of Huck equipment from qualified personnel. proceed logically, eliminating each possible cause until the defective part is located. Where possible, substitute known good parts for suspected defective parts. Use Trouble Shooting Chart as an aid for locating and correcting trouble.



## Operating Instructions

This tool is shipped with an attached regulator and a 1/4" inside diameter air hose (Huck p/n 115436), with a plastic plug in the air inlet connector. An air supply capable of 6.3 CFM at a pressure greater than 10 psi greater than the installed regulator set point (Figure 16) must be available. Air supply should be equipped with a filter-regulator-lubricator unit.



### WARNINGS:

**Read full manual before using tool.**

Inspect tool for damage or wear before each use. Do not operate if damaged or worn, as severe personal injury may occur.

A half-hour training session with qualified personnel is recommended before using Huck equipment.

When operating Huck installation equipment, always wear approved eye protection.

Be sure there is adequate clearance for the operator's hands before proceeding.

To avoid severe personal injury: Wear approved eye and ear protection. Be sure of adequate clearance for Operator's hands before proceeding with fastener installation. Be sure that pintail deflector is on tool and directed away from all personnel.

Do not pull on a pin without placing fastener/collar in a workpiece, and also, collar chamfer **MUST** be out toward tool - these conditions cause pin to eject with great velocity and force when the pintail breaks off or teeth/grooves strip. This may cause severe personal injury.



### CAUTIONS:

Do not let disconnected hoses and couplers contact a dirty floor. Keep harmful material out of hydraulic fluid. Dirt in hydraulic fluid causes valve failure in Tool and In Powerig Hydraulic Unit.

Do not use TEFLON® tape on pipe threads. Pipe threads may cause tape to shred resulting in tool malfunction. (Threadmate™ is available from Huck in a 4oz. tube as part number 508517.)

Remove excess gap from between the sheets to permit correct fastener installation and prevent jaw damage. **ALL** jaw teeth must engage pintail to avoid damaging teeth.

BOM blind fasteners jam in nose assembly if pulled when not in workpiece.

To avoid structural and tool damage, be sure enough clearance is allowed for nose assembly at full stroke.

Do not abuse tool by dropping it, using it as a hammer or otherwise causing unnecessary wear and tear.

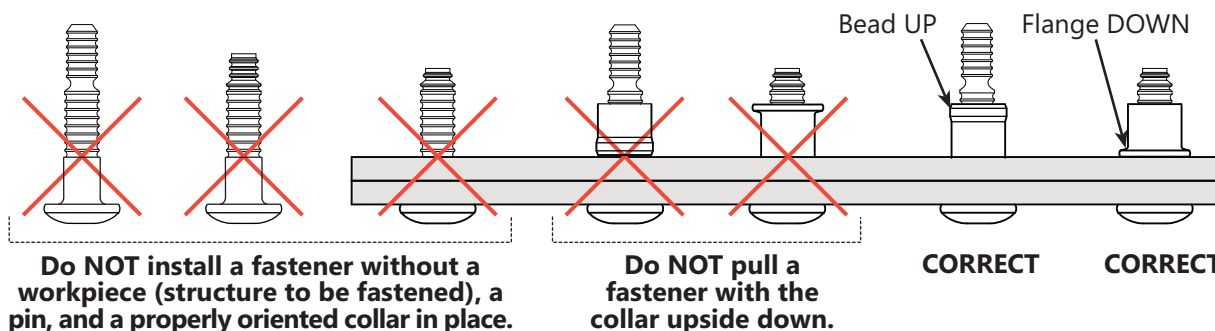

### HUCKBOLT® FASTENER INSTALLATION:

Place pin in workpiece and place collar over pin. See WARNING. (If Collar has only one tapered end, that end **MUST** be out toward tool - not next to workpiece.) Hold pin and push nose assembly onto pin protruding through collar until nose anvil touches collar. Depress trigger and hold until collar is swaged and pintail breaks. Release trigger. Tool will go into RETURN stroke. Tool and nose are ready for next installation cycle.

### BLIND FASTENER INSTALLATION:

Fastener may be placed in workpiece or in end of nose assembly. See WARNING. In either case, tool/nose must be held against work and at right angles to it. Depress and hold trigger until fastener is installed and pintail breaks. Release trigger. Tool will go into its return stroke. Tool/nose are ready for next installation cycle.





## Maintenance



**CAUTION: Do not use TEFLON® tape on pipe threads. Pipe threads may cause tape to shred resulting in tool malfunction.**

### GOOD SERVICE PRACTICES

The efficiency and life of an installation tool depends upon proper maintenance and good service practices. Read this entire page before proceeding with maintenance/repair.

Individual parts must be handled carefully and examined for damage or wear. Replace parts where required. Always replace O-rings and back-up rings when the tool is disassembled for any reason.

Use proper hand tools in a clean well lit area for maintenance and/or repair. Always be careful to keep dirt and debris out of pneumatic and hydraulic systems. Only standard hand tools are required in most cases. Where a special tool is required, the description and part number are given.

While clamping installation tool and/or parts in a vise, and when parts require force, use suitable soft materials to cushion impact. For example, using a half-inch brass drift, wood block and/or vise with soft jaws greatly diminishes the possibility of a damaged tool. Remove components in a straight line without bending, cocking or undue force, and reassemble tool with the same care.

Consult Troubleshooting section of this manual if a malfunction occurs. Where a part number (P/N) is given, HUCK sells that part.

### FLUID MAINTENANCE

For fluid maintenance please refer to NAS 1638 class 9 or ISO CODE 18/15 or SAE level 6

### STANDARD SEALANTS AND LUBRICANTS

Coat hose fitting threads with a non-hardening TEFLON® thread compound such as Threadmate™, which is available from HUCK in a 4oz. tube as part number 508517.

Smear LUBRIPLATE® 130AA, or equivalent lubricant, on O-rings and mating surfaces this prevents nicking/pinching O-rings on any rough/tight spot and increases ease of assembly. (LUBRIPLATE 130AA is available from HUCK in a tube as part number 502723.)

### SERVICE PARTS KIT

Service parts kit 2480KIT contains perishable parts for both the 2480 and 2481 family of tools. For convenience, and as experience indicates, keep extra kits (O-rings, back-up rings, and other standard items) and tool parts on hand. Inspect tool daily. Check hoses, fittings and disconnects for leaks or damage.

### Preventive Maintenance

#### SYSTEM INSPECTION

Operating efficiency of the tool is directly related to performance of the complete system, including tool and nose assembly, hydraulic hoses, control trigger assembly and the Powerig® Hydraulic Unit. An effective preventive maintenance program includes scheduled inspections of the system to detect and correct minor troubles.

1. Inspect tool for external damage.
2. Verify that hoses and fittings, and trigger connections are secure.
3. Inspect hydraulic hoses for signs of damage. Replace if required.
4. Inspect tool, hoses, and Powerig Hydraulic Unit during operation to detect abnormal heating, leaks or vibration.

### POWERIG® HYDRAULIC POWER SOURCE

Maintenance and repair instructions are in applicable Powerig Hydraulic Unit Instruction Manual.

Tool and Nose Assembly Maintenance and Precautions  
Whenever disassembled, and also at regular intervals (depending on severity and length of use), replace all O-rings and back-up rings. Spare Parts Kits should be kept on hand. Inspect cylinder bore, piston and rod/extension, and unloading valve for scored surfaces, excessive wear or damage, and replace parts as necessary. On any assembly with UNITIZED™ Jaws, clean all parts in mineral spirits or isopropyl alcohol only. Under no circumstances should jaws come in contact with other solvents. Also, do not let jaws soak; dry the jaws immediately after cleaning. Dry other parts before assembling. Urethane soaks up other solvents, then swells up and becomes unusable. Use a sharp pointed pick to remove embedded particles from the pull grooves of the jaws.

**Figure 5**





## Disassembly Procedure

The following procedure is for complete disassembly. Disassemble only subassemblies necessary to check and replace damaged seals, wipers, back-up rings and components. Always replace seals, wiper, O-rings and back-up rings of disassembled subassemblies.



**WARNING: Disconnect tool control trigger system from Powerig® Hydraulic Unit before disconnecting tool hydraulic hoses from unit. If not disconnected in this order, severe personal injury may occur.**

1. Read WARNING. Disconnect tool's electrical connector from the hydraulic unit; then uncouple tool's hydraulic hoses and drain into a container.
2. Remove tool retaining nut using 1-1/16 open-end wrench. Slide nose assembly anvil away from tool. Unscrew collet from tool piston.
3. Unscrew four screws from handle assembly. Remove the screws and nuts, and separate handle halves. (Figure 6)

**Figure 6 TOOL FRONT - HANDLE HALVES SEPARATED**

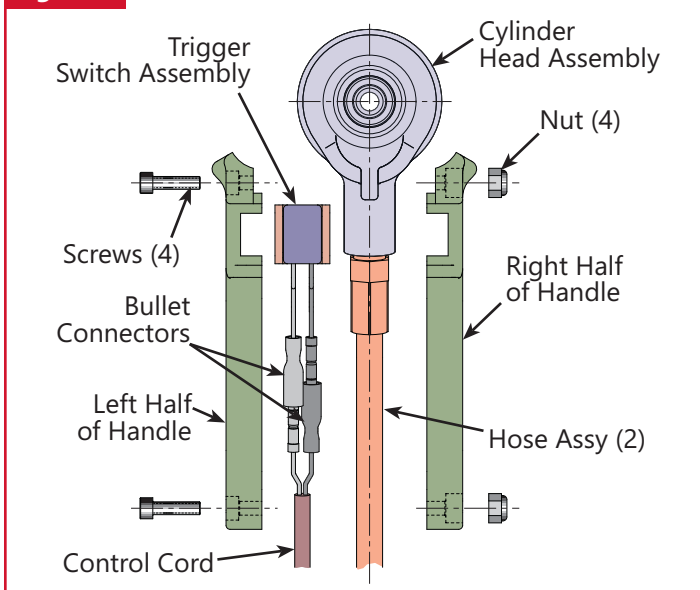

4. (Optional) Unscrew hydraulic hoses from tool.  
**NOTE: Do not remove hydraulic hoses from tool unless replacing them.**
5. Remove quick disconnects from hoses, and push rearward on piston until remaining hydraulic fluid is drained into container, and discard fluid.
6. **Electric Trigger Models:** Lift trigger switch assembly from handle half. Pull control cord out of built-in handle strain relief. Pull both bullet connectors apart. (Figure X)

**Air Trigger Models:** Lift air trigger assembly from handle half. Pull air hose out of handle's built-in strain relief. (Figure 10)

7. **Electric Trigger Models:** Disassemble switch and cord assembly as instructed in Figure 7.

**Air Trigger Models:** Disassemble air trigger and hose assembly as instructed in Figure 8.

**Figure 7 ELECTRIC TRIGGER ASSEMBLY**

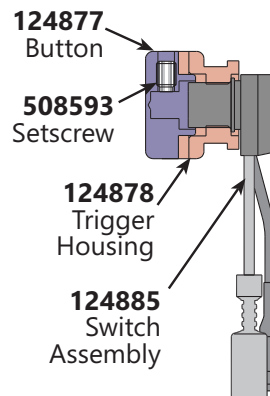

### Disassembly Procedure:

1. Loosen Setscrew using 5/64 hex key.
2. Remove Button.
3. Unscrew Switch from Housing.

**Figure 8 AIR TRIGGER AND HOSE ASSEMBLY**

### Disassembly Procedure

*NOTE: When removing air hose from either fitting, slice hose lengthwise, at fitting, just enough to remove easily. Then, cut hose squarely across to be ready for assembly.*

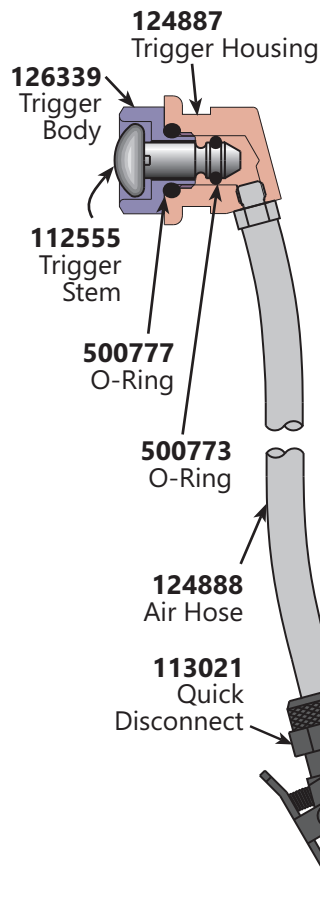

1. Unscrewing nut from quick disconnect body; then cut and remove Air Hose.
2. Remove Air Hose from Air Trigger Housing.
3. Unscrew Trigger Body from Housing.
4. Remove O-ring from Trigger Stem, and pull Stem out.
5. Remove O-ring from Housing.



## Disassembly Procedure

### DISASSEMBLE CYLINDER ASSEMBLY

1. Place spacer over threaded end of piston; then thread piston assembly tool onto the piston. If the cylinder contains fluid, push the piston rearward and drain the fluid into a container. Discard the fluid.
2. Remove pintail deflector from end cap by twisting and pulling in one motion.
3. With a 1-5/16 open-end wrench, unscrew end cap.
4. Using optional Piston Assembly Tool, press piston, with unloading valve, and end cap/rear gland out through the rear of the tool. (Figure 9)
5. Slide end cap and unloading valve from piston; then remove piston insertion tool and spacer.
6. Use a small diameter pointed rod to remove all seals, wipers, O-rings and back-up rings from components and discard them. **Do not re-use any seals.** Clean parts, including O-ring grooves. Examine all components for wear or defects, and replace as required.

Figure 9

### TOOL SHOWN WITH HANDLE HALVES REMOVED AND PISTON ASSEMBLY TOOL INSTALLED

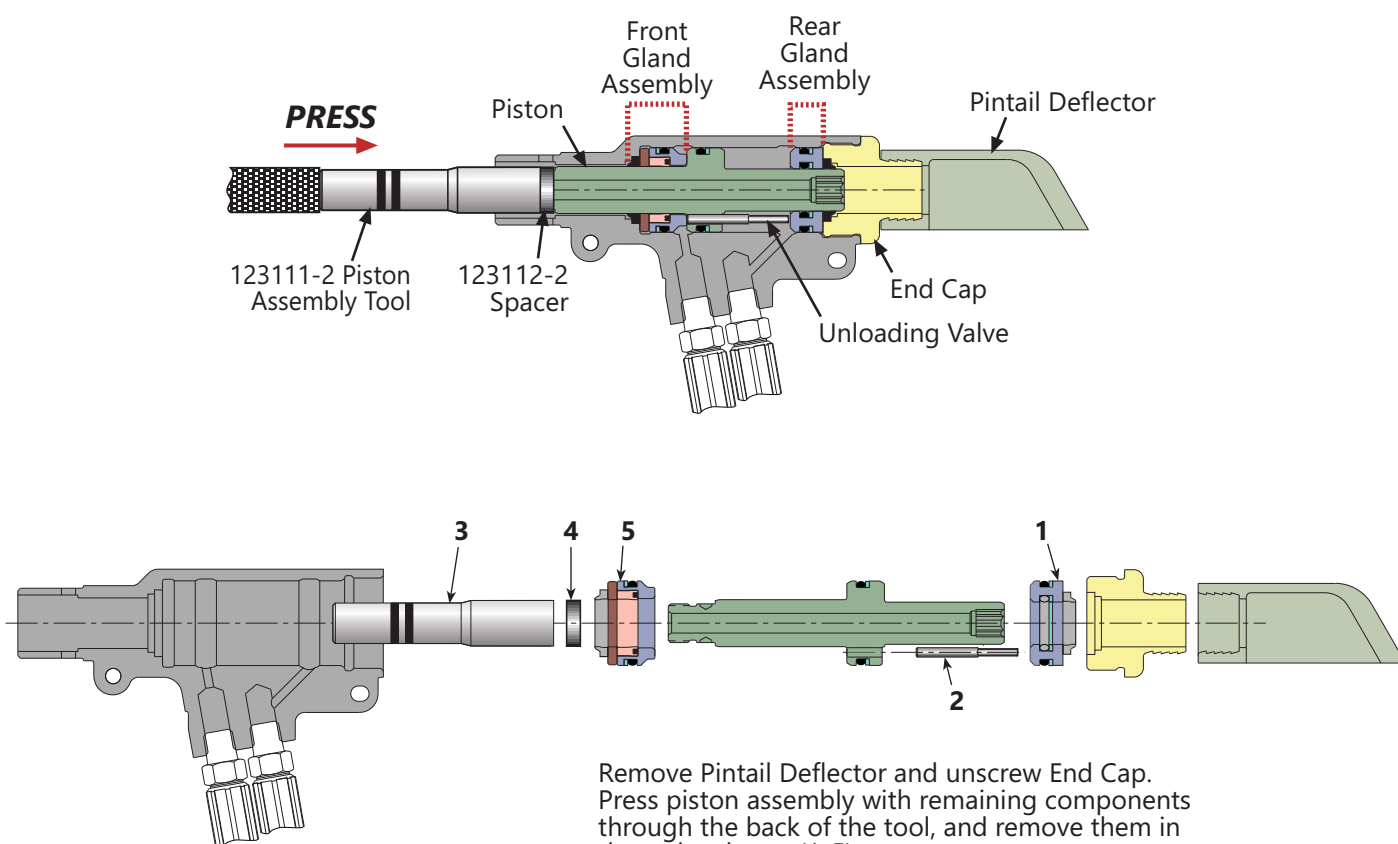

Remove Pintail Deflector and unscrew End Cap. Press piston assembly with remaining components through the back of the tool, and remove them in the order shown (1-5). Remove and discard all seals from subassemblies.



## Assembly Procedure

Clean out O-ring grooves and reinstall perishable parts (seals, etc.) using service kit 2480KIT. **NOTE: The small inner ring insert of polyseals must remain positioned as shown. If it is forced out of seal body, it may be pinched against gland inner edge. A damaged seal will permit leakage.**



**CAUTION: Do not use TEFLON® tape on pipe threads. Pipe threads may cause tape to shred resulting in tool malfunction.**

1. Thinly coat Parker SUPER O-LUBE, or equivalent, on seals and mating surfaces. **Note the orientation of all O-rings, back-up rings, wipers, and polyseals of piston, front gland, and rear gland, and install them accordingly.** (Figure 10)
2. Thread piston assembly tool onto piston. Lubricate all mating surfaces. Press evenly against gland cap to slide front gland assembly over piston assembly tool and into piston. Slide wiper onto piston as shown. Install unloading valve into piston. **NOTE: The long flats of the unloading valve must be oriented toward the rear of the tool.**
3. Thread piston insertion tool into cylinder. Lightly coat internal surfaces of tool and cylinder with lubricant.
4. Lightly coat cylinder, piston O-rings, and front gland O-rings with lubricant. While supporting tool in a soft vise, press assembled piston and components into cylinder. Remove piston assembly tool.
5. Lightly coat cylinder and rear gland O-rings with lubricant. Hold cylinder upright on a bench or in a vice fitted with soft jaws. Install rear gland assembly using suitable spacer, plate, and soft mallet.
6. Press wiper into groove of end cap. Thread end cap into cylinder and tighten. Install deflector.
7. Assemble hoses to cylinder head assembly. Use Slicite® TEFLON® thread compound, or equivalent, on pipe threads. See Caution above. Hose with male connector must be on PULL (front) side of cylinder.
8. Assemble switch assembly for Electric or Air Trigger.
9. Assemble handle assembly to tool.

### ASSEMBLING HANDLE TO TOOL

#### 1. Electric Trigger Models:

- a. Screw switch into housing.
- b. Slide button onto switch.
- c. Tighten setscrew using 5/64 hex key.

#### Air Trigger Models:

**NOTE: To ease assembly, heat ends of hose before pushing onto fittings. When using a new disconnect, remove and discard plastic ferrule from nut before attaching air hose.**

- a. Push O-ring over threads of air trigger body.
  - b. Push stem through body. Stretch O-ring over stem and into groove.
  - c. Screw trigger into housing.
  - d. Screw hose fitting into housing. Push hose onto fitting.
  - e. Slide nut over hose. Push hose onto quick disconnect. Tighten nut.
2. Position assembled cylinder and hoses in left handle half. Align right handle half with left (locators help align halves).
  3. Insert locknuts and screws into handle. Tighten screws.

**GLANDS, PISTON, AND VALVE ASSEMBLY** Figure 10

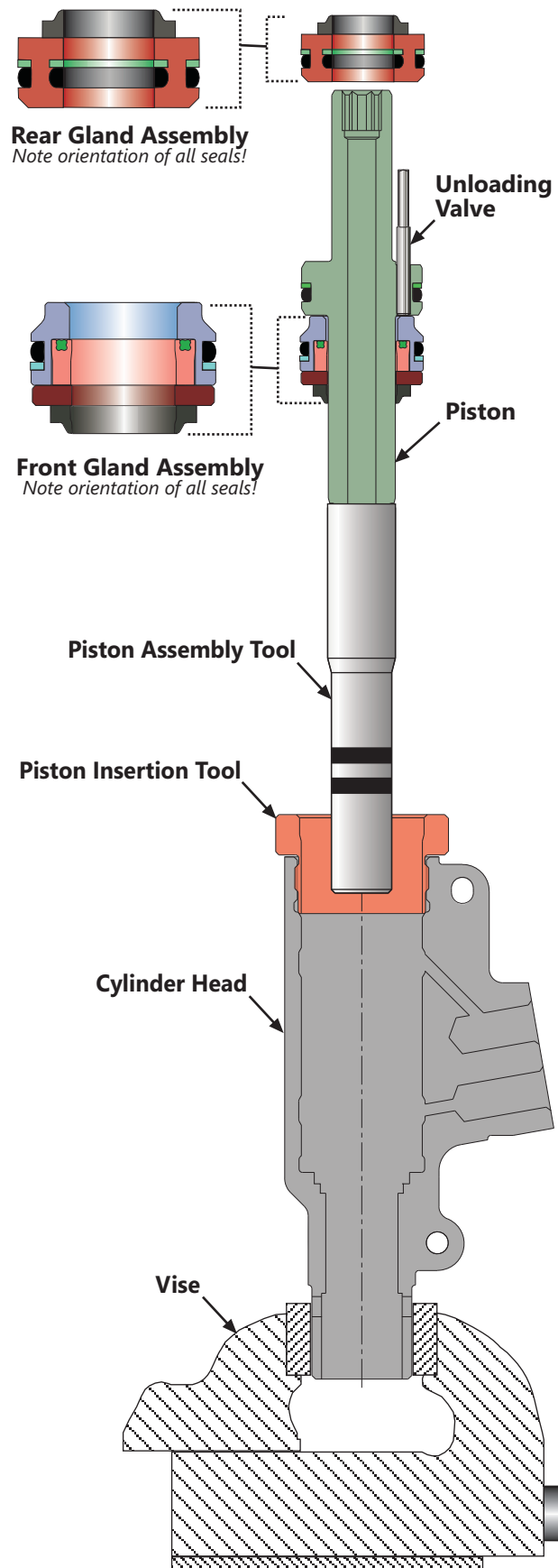

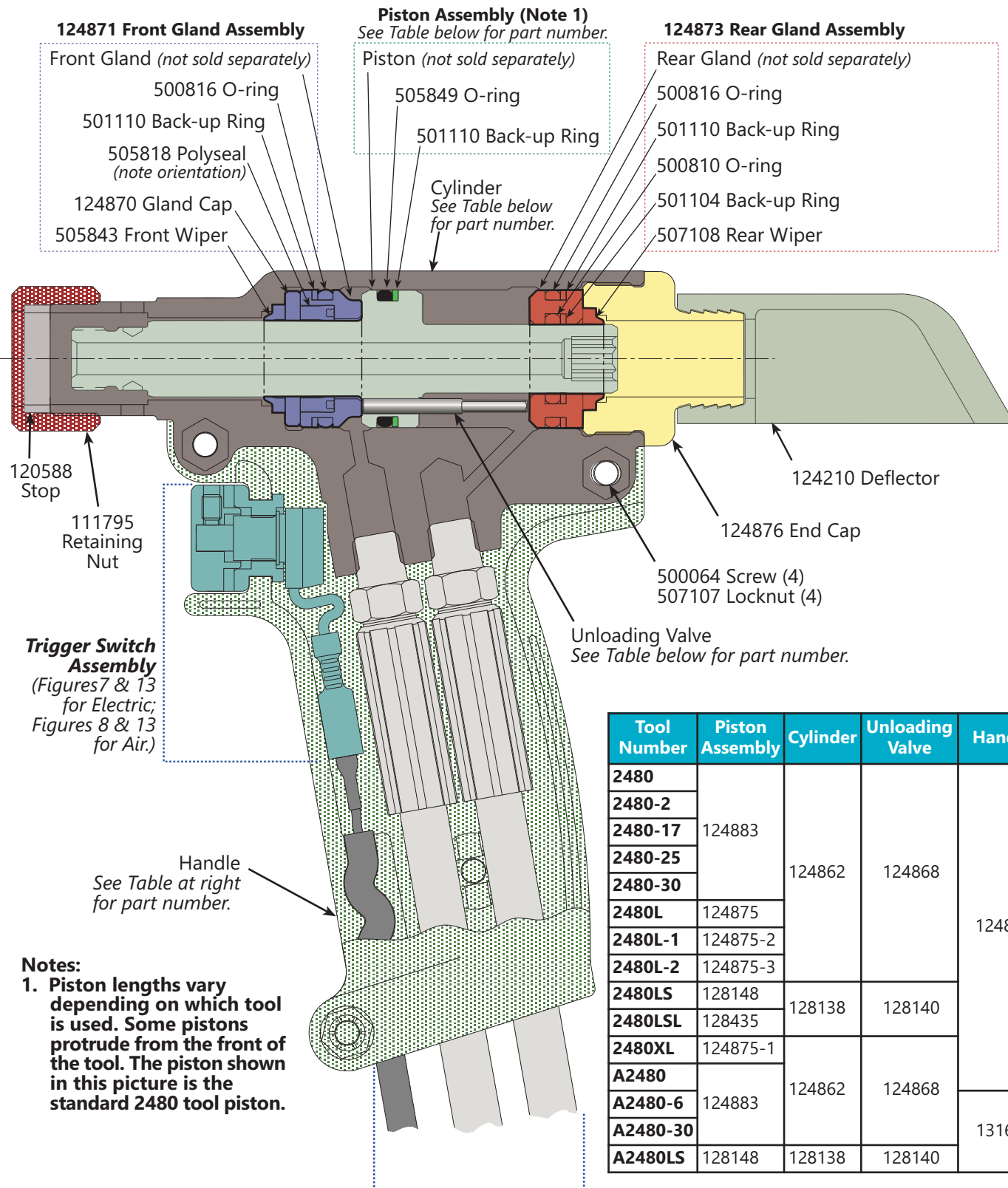

## 2480 series Components

**Figure 11**

Tool Number	Piston Assembly	Cylinder	Unloading Valve	Handle
2480	124883	124862	124868	124867
2480-2				
2480-17				
2480-25				
2480-30				
2480L	124875	128138	128140	
2480L-1	124875-2			
2480L-2	124875-3			
2480LS	128148	128138	128140	
2480LSL	128435			
2480XL	124875-1	124862	124868	131625
A2480	124883			
A2480-6				
A2480-30				
A2480LS	128148	128138	128140	

See Figure 13 for Electric Trigger, Hoses, and Cord part numbers.  
See Figure 14 for Air Trigger and Hoses part numbers.





## 2481 series Components

**Figure 12**

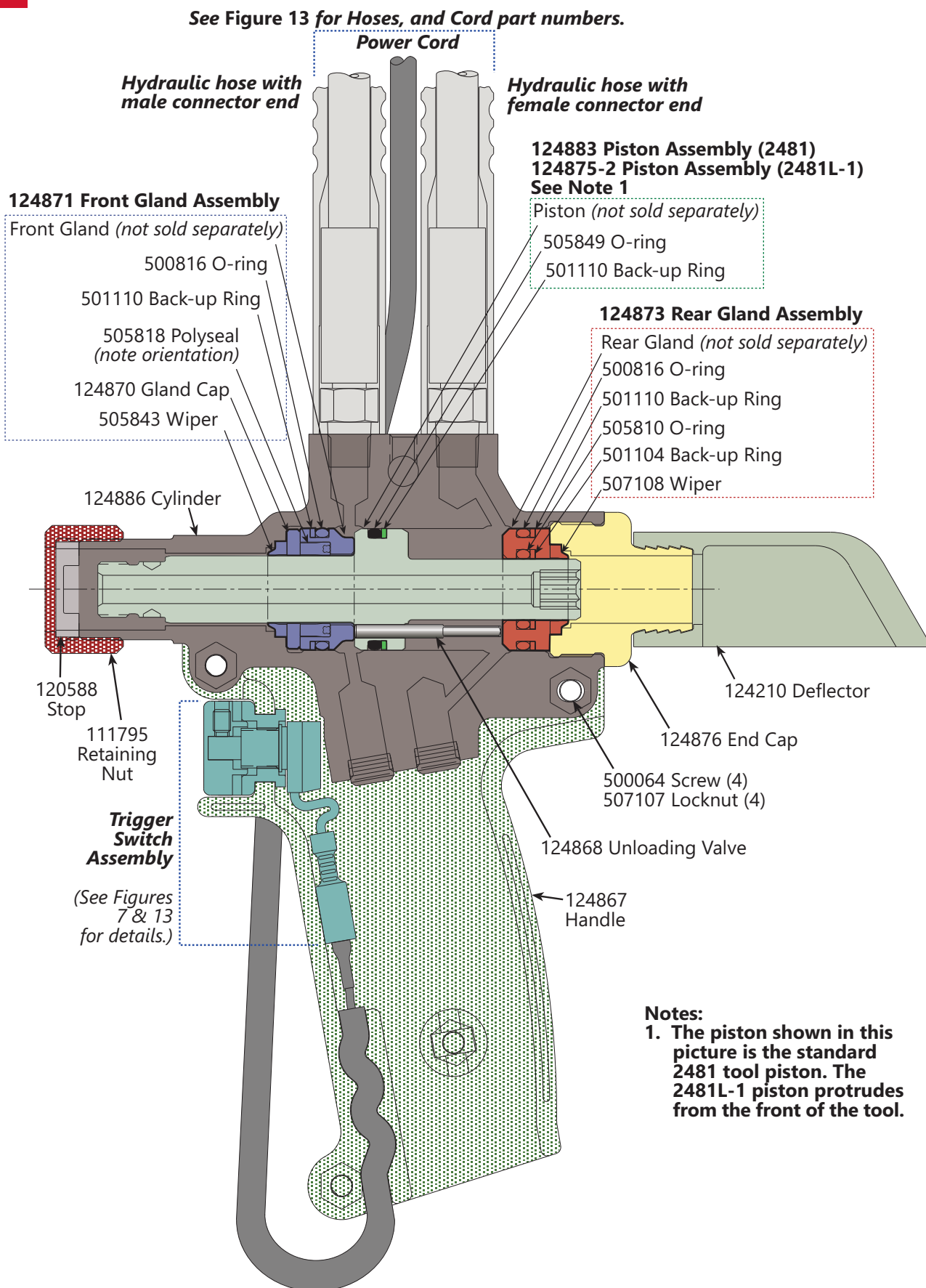

**Notes:**

1. The piston shown in this picture is the standard 2481 tool piston. The 2481L-1 piston protrudes from the front of the tool.



## Hydraulic Hoses and Electric Trigger and Cord

**Figure 13**

Tool Number	Hose Number	Hose Length	Control Cord Assembly Number	Cord Length
<b>2480</b>	HPHX12-AA10	12 ft.	124880	13 ft.
<b>2480-2</b>	HPHX2-AA10	2 ft.	124880-3	3 ft.
<b>2480-17</b>	HPHX17-AA10	17 ft.	124880-4	2 ft.
<b>2480-25</b>	HPHX25-AA10	25 ft.	124880-2	17 ft.
<b>2480-30</b>	HPHX30-AA10	30 ft.	124880-5	25 ft.
<b>2480L</b>	124881-1	12 ft.	124880	13 ft.
<b>2480L-1</b>				
<b>2480L-2</b>				
<b>2480LS</b>				
<b>2480LSL</b>				
<b>2480XL</b>				
<b>2481</b>				
<b>2481L-1</b>				

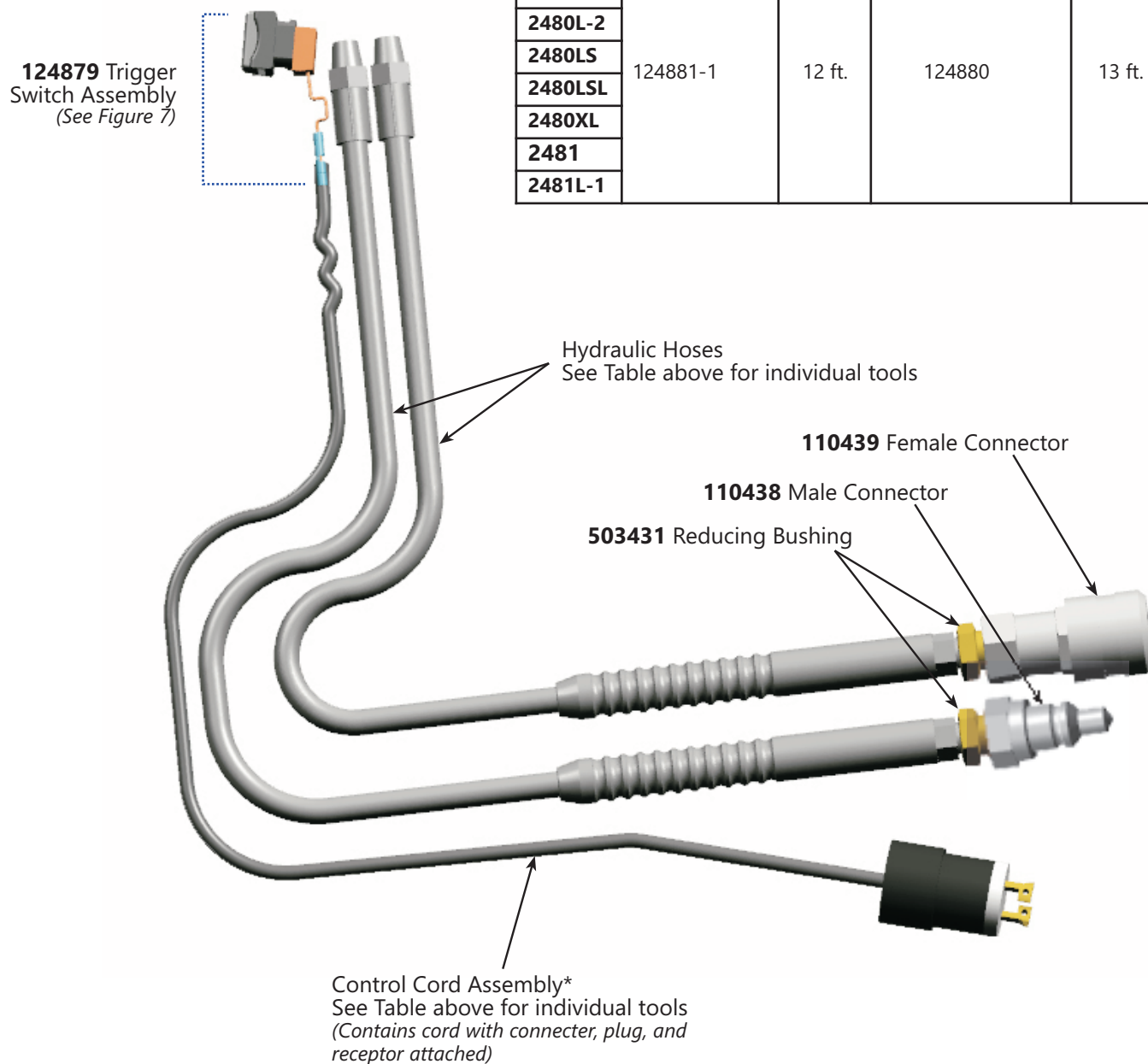



## Air Hoses and Trigger and Cord

**Figure 14**

Tool Number	Hose Number	Hose Length	Air Hose Assembly Number	Air Hose Length
<b>A2480</b>	124881-1	12 ft.	124889	13 ft.
<b>A2480-6</b>	124881-2	6 ft.	124889-1	6.5 ft.
<b>A2480-30</b>	HPHX30-AA10	30 ft.	124889-2	31 ft.
<b>A2480LS</b>	124881-1	12 ft.	124889	13 ft.

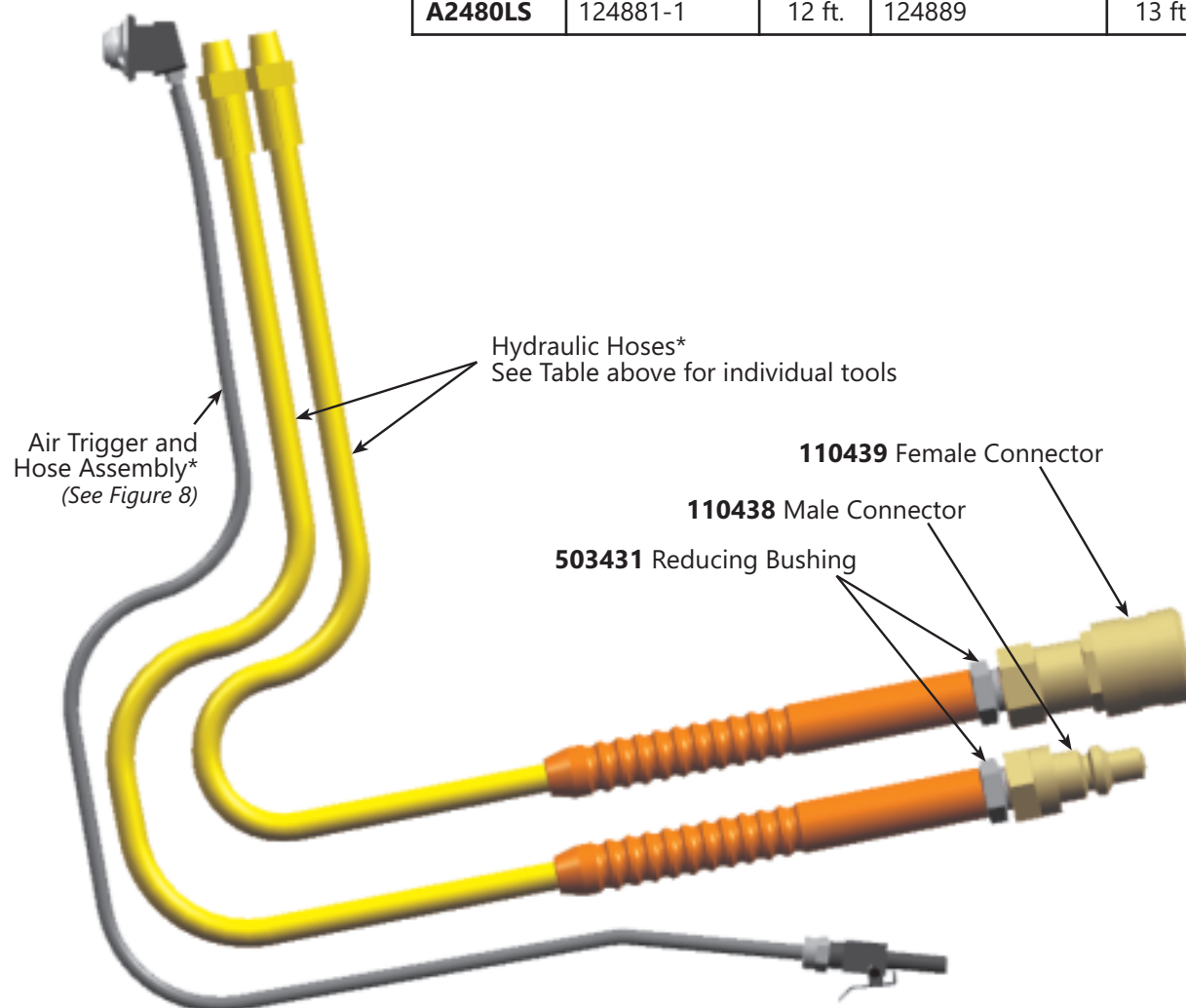

\* Tools are shipped standard with 12 ft. hoses and cord. For other lengths available, see OPTIONAL EQUIPMENT.



## Optional Equipment

<b>Pressure Gauge</b>	<b>T-124833CE</b>	<b>Hose and Cord Kits</b>	<b>Hose Length</b>	<b>Part No.</b>
		(Contains control cord assembly and both hydraulic hoses with male and female quick connect fittings at each end)	- 6 ft - 12 ft - 26 ft - 38 ft - 52 ft	118309-6 118309-12 118309-26 118309-38 118309-52
<b>Service Parts Kit</b> (Includes all perishable seals, O-rings, and Back-up rings. A spare Service Parts Kit should be kept on hand at all times.)	<b>2480KIT</b>	<b>Individual Hoses</b>	<b>Hose Length</b>	<b>Part No.</b>
		<b>NOTES:</b>	- 2 ft - 6 ft - 12 ft - 17 ft - 25 ft - 30 ft - 38 ft - 40 ft - 50 ft	HPHX02-AA10 HPHX06-AA10 HPHX12-AA10 HPHX17-AA10 HPHX25-AA10 HPHX30-AA10 HPHX38-AA10 HPHX40-AA10 HPHX50-AA10
		1. <i>These hoses do not have reducing bushings or quick connect fittings at each end.</i>		
		2. <i>These hoses are directly interchangeable with the 124881 series hoses.</i>		
<b>Pintail Bottle Assembly</b> (To convert tool to 2480B)	<b>128017</b>			
<b>Piston Assembly Tool Kit</b> Includes: Piston Assembly Tool Spacer Polyseal Insertion Tool	<b>123110-2 (Standard)</b>  - 123111-2 - 123112-2 - 121694-202			
<b>Piston Assembly Tool Kit</b> Includes: Piston Assembly Tool Spacer Polyseal Insertion Tool	<b>123110-4 (L / XL)</b>  - 123111-4 - 123112-3 - 121694-202	<b>TEFLON® Stick</b> <b>TEFLON® Sealant</b> <b>Loctite® 243</b> <b>Never-Seez® NS-160</b> (anti-seize and lubricating compound) <b>LUBRIPLATE® 130-AA</b> <b>Threadmate™</b> (4oz. tube)	<b>- 503237</b> <b>- 620012</b> <b>- 508567</b> <b>- 505565</b> <b>- 502723</b> <b>- 508517</b>	
<b>Control Cord Assembly</b> (Contains cord with connector, plug, and receptor attached)	<b>Cord Length</b> - 2.5 ft - 3.5 ft - 4.5 ft - 13.3 ft - 17.75 ft - 26 ft - 30.75 ft - 39 ft	<b>Part No.</b> 124880-6 124880-1 124880-9 124880-8 124880-4 124880-2 124880-5 124880-10		

## Sticker Locations

The 2480 and 2481 series tools come labeled with:

### Safety and pressure sticker, part number 590424

This sticker contains safety and pressure settings information. It is necessary that this sticker remain on the tool and is easily read. If sticker becomes damaged or worn, or if it have been removed from the tool, or **when replacing Cylinder, this sticker must be ordered and placed in the location shown.**

**Figure 4** PLACEMENT OF CE, CAUTION, AND WARNING STICKER

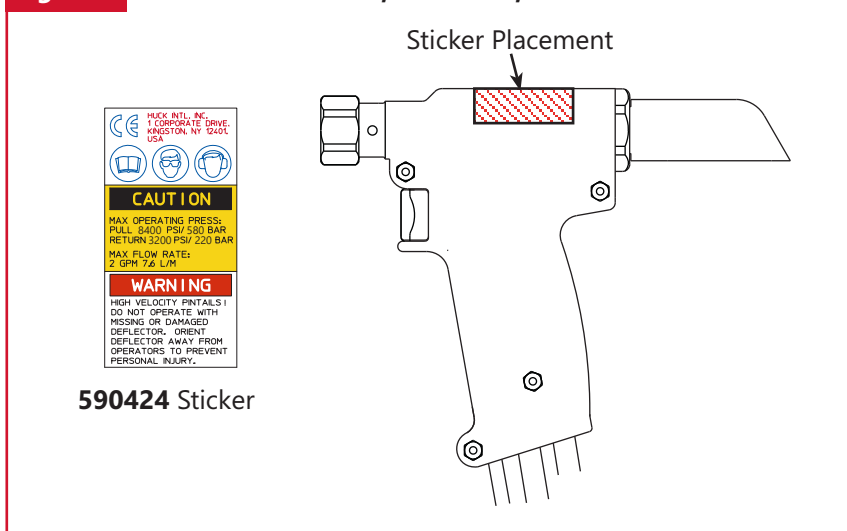



## Troubleshooting

Always check the simplest possible cause of a malfunction first. For example, a loose or disconnected trigger line. Then proceed logically, eliminating each possible cause until the defective part is located. Where possible, substitute known good parts for suspected defective parts. Use Trouble Shooting Chart as an aid for locating and correcting trouble.

- 1. Tool fails to operate when trigger is depressed:**
  - a. Inoperative Powerig® Hydraulic Unit - see applicable instruction manual
  - b. Loose air or electric connections
  - c. Damaged trigger assembly
  - d. Loose or faulty hydraulic hose coupling
  - e. Unloading valve not installed in tool
- 2. Tool operates in reverse:**
  - a. Reversed hydraulic hose connections between Powerig and tool
- 3. Tool leaks hydraulic fluid:**
  - a. Defective Tool O-rings or loose hose connections at tool
- 4. Hydraulic couplers leak fluid:**
  - a. Damaged or worn O-rings in coupler body — see Coupler, 110440
- 5. Hydraulic fluid overheats:**
  - a. Hydraulic unit not operating properly — see manual
  - b. Unloading valve installed incorrectly
  - c. Powerig Hydraulic Unit running in reverse (918; 918-5 only) — see Powerig instruction manual
- 6. Tool operates erratically; fastener not installed properly:**
  - a. Low or erratic hydraulic pressure — air in system
  - b. Damaged or worn piston O-ring in tool
  - c. Unloading valve installed incorrectly
  - d. Excessive wear on sliding surfaces of tool parts
  - e. Excessive wear of unloading valve in tool
- 7. Grooves on fastener pintail stripped during PULL stroke:**
  - a. Operator not sliding anvil completely onto fastener pintail
  - b. Incorrect fastener grip
  - c. Worn or damaged jaw segments
  - d. Metal particles in pull grooves of jaw segments
  - e. Excessive sheet gap
- 8. Collar of HUCKBOLT® fastener not completely swaged:**
  - a. Improper tool operation — see Trouble 6
  - b. Scored anvil
- 9. Shear collar on Huck blind fastener not driven:**
  - a. Improper tool operation
  - b. Worn or damaged driving anvil in nose assembly
- 10. Tool “hangs-up” on swaged collar of HUCKBOLT fastener:**
  - a. Improper Tool operation — see Trouble 6
  - b. RETURN pressure too low
  - c. Nose assembly not installed correctly
- 11. Pintail of fastener fails to break:**
  - a. Improper Tool operation — see Trouble 6
  - b. Pull grooves on fastener stripped — see Trouble 7
  - c. PULL pressure too low
  - d. Worn unloading valve





## Limited Warranties

### Limited Lifetime Warranty on BobTail® Tools:

Huck International, Inc. warrants to the original purchaser that its BobTail® installation tools manufactured after 12/1/2016 shall be free from defects in materials and workmanship for its useful lifetime. This warranty does not cover special order / non-standard products, or part failure due to normal wear, tool abuse or misapplication, or user non-compliance with the service requirements and conditions detailed in the product literature.

### Two Year Limited Warranty on Installation Tools:

Huck International, Inc. warrants that its installation tools and Powerig® hydraulic power sources manufactured after December 1, 2016 shall be free from defects in materials and workmanship for a period of two years from date of purchase by the end user. This warranty does not cover special order / non-standard products, or part failure due to normal wear, tool abuse or misapplication, or user non-compliance with the service requirements and conditions detailed in the product literature.

### 90 Day Limited Warranty on Nose Assemblies and Accessories:

Huck International, Inc. warrants that its nose assemblies and accessories shall be free from defects in materials and workmanship for a period of 90 days from date of purchase by the end user. This warranty does not cover special clearance noses, or special order / non-standard product, or part failure due to normal wear, abuse or misapplication, or user non-compliance with the service requirements and conditions detailed in the product literature.

Useful lifetime is defined as the period over which the product is expected to last physically, up to the point when replacement is required due to either normal in-service wear, or as part of a complete overhaul. Determination is made on a case-by case basis upon return of parts to Huck International, Inc. for evaluation.

### Tooling, Part(s) and Other Items not manufactured by Huck:

HUCK makes no warranty with respect to the tooling, part(s), or other items manufactured by third parties. HUCK expressly disclaims any warranty expressed or implied, as to the condition, design, operation, merchantability, or fitness for use of any tool, part(s), or other items thereof not manufactured by HUCK. HUCK shall not be liable for any loss or damage, directly or indirectly, arising from the use of such tooling, part(s), or other items or breach of warranty or for any claim for incidental or consequential damages.

Huck shall not be liable for any loss or damage resulting from delays or non-fulfillment of orders owing to strikes, fires, accidents, transportation companies or for any reason or reasons beyond the control of the Huck or its suppliers.

### Huck Installation Equipment:

Huck International, Inc. reserves the right to make changes in specifications and design and to discontinue models without notice.

Huck Installation Equipment should be serviced by trained service technicians only.

Always give the serial number of the equipment when corresponding or ordering service parts.

Complete repair facilities are maintained by Huck International, Inc. Please contact one of the offices listed below.

#### Eastern

One Corporate Drive Kingston, New York 12401-0250  
Telephone (845) 331-7300 FAX (845) 334-7333

#### Outside USA and Canada

Contact your nearest Huck International location (see reverse).

In addition to the above repair facilities, there are Authorized Tool Service Centers (ATSC's) located throughout the United States. These service centers offer repair services, spare parts, Service Parts Kits, Service Tool Kits and Nose Assemblies. Please contact your Huck Representative or the nearest Huck International location (see reverse) for the ATSC in your area.



**ARCONIC**

Arconic Inc. (NYSE: ARNC) creates breakthrough products that shape industries. Working in close partnership with our customers, we solve complex engineering challenges to transform the way we fly, drive, build and power. Through the ingenuity of our people and cutting-edge advanced manufacturing, we deliver these products at a quality and efficiency that ensures customer success and shareholder value.

## Arconic Fastening Systems Tooling Support Locations

### INDUSTRIAL NORTH AMERICA

Kingston Operations  
1 Corporate Drive  
Kingston, NY 12401  
Tel: +1-800-278-4825  
Fax: +1-845-334-7333  
afs.sales.kingston@arconic.com

Tracy Operations (IDG)  
1925 North MacArthur Drive  
Tracy, CA 95376  
Tel: +1-800-826-2884  
Fax: +1-800-573-2645  
afs.sales.idg@arconic.com

Waco Operations  
PO Box 8117  
8001 Imperial Drive  
Waco, TX 76714-8117  
Tel: +1-800-388-4825  
Fax: +1-800-798-4825  
afs.sales.waco@arconic.com

### INDUSTRIAL GLOBAL

Kolkata Operations  
Unit No. 28, 2nd Floor,  
55/1, Chowringhee Road,  
Kolkata 700071, West Bengal, India  
Tel: +91-33-40699170  
Tel: +91-33-40699180  
Fax: +91-33-40699184

Melbourne Operations  
1508 Centre Road  
Clayton, Victoria  
Australia 3168  
Tel: +613-8545-3333  
Fax: +613-8545-3390  
afs.sales@arconic.com

São Paulo Operations  
Rodovia Anhanguera, s/n, KM 17  
Parque São Domingos - Complexo  
Anhanguera - Galpão 1 Seção III  
(Módulo III) Box 11  
CEP 05112-000 São Paulo - SP Brazil  
Tel: +55-11-3583-7061

Suzhou Operations  
58 Yinsheng Road,  
SIP Suzhou, Jiangsu  
215126 China  
Tel: +86-512-62863800-8888

Telford Operations  
Unit C, Stafford Park 7  
Telford, Shropshire  
England TF3 3BQ  
Tel: +44-(0)-1952-290011  
Fax: +44-(0)-1952-207701  
thisales@arconic.com

Tokyo Operations (Japan and Korea)  
1013 Hibiya U-1 Bldg.  
Uchisaiwai-cho 1-1-7  
Chiyoda-ku, Tokyo  
100-0011 Japan  
Tel: +81-3-3539-6594  
Fax: +81-3-3539-6585

### AEROSPACE NORTH AMERICA

Kingston Operations  
1 Corporate Drive  
Kingston, NY 12401  
Tel: +1-800-278-4825  
Fax: +1-845-334-7333  
afs.sales.kingston@arconic.com

Simi Valley Operations  
3990A Heritage Oak Court  
Simi Valley, CA 93063  
Tel: +1-805-527-3600  
Fax: +1-805-527-0900  
www.afs-simivalley.com

### AEROSPACE GLOBAL

Aichach Operations  
Robert-Bosch Str. 4  
Aichach 86551  
Germany  
Tel: +49-8251-8757-0  
aicaufswelcomedl@arconic.com

Cergy Operations  
15 Rue du Petit Albi  
F-95611 Cergy Pontoise  
France  
Tel: +33-1-34-33-98-00  
Fax: +33-1-34-33-97-77

Hong Kong Operations  
27th Floor, 88 Hing Fat Street  
Causeway Bay  
Hong Kong, China  
Tel: +852-2864-2012



© 2018 Huck International, Inc.  
**Arconic Fastening Systems**  
**Kingston Operations**  
1 Corporate Drive, Kingston, NY 12401  
Tel: 800-431-3091 • Fax: 845-334-7333  
[www.afshuck.net/us](http://www.afshuck.net/us)



Huck provides technical assistance regarding the use and application of Huck fasteners and tooling. NOTICE: The information contained in this publication is only for general guidance with regard to properties of the products shown and/or the means for selecting such products, and is not intended to create any warranty, express, implied, or statutory; all warranties are contained only in Huck's written quotations, acknowledgments, and/or purchase orders. It is recommended that the user secure specific, up-to-date data and information regarding each application and/or use of such products.